

# LS200 / LS250

MONTAGEHANDLEIDING - ASSEMBLY MANUAL - MONTAGEANLEITUNG - MANUEL DE MONTAGE

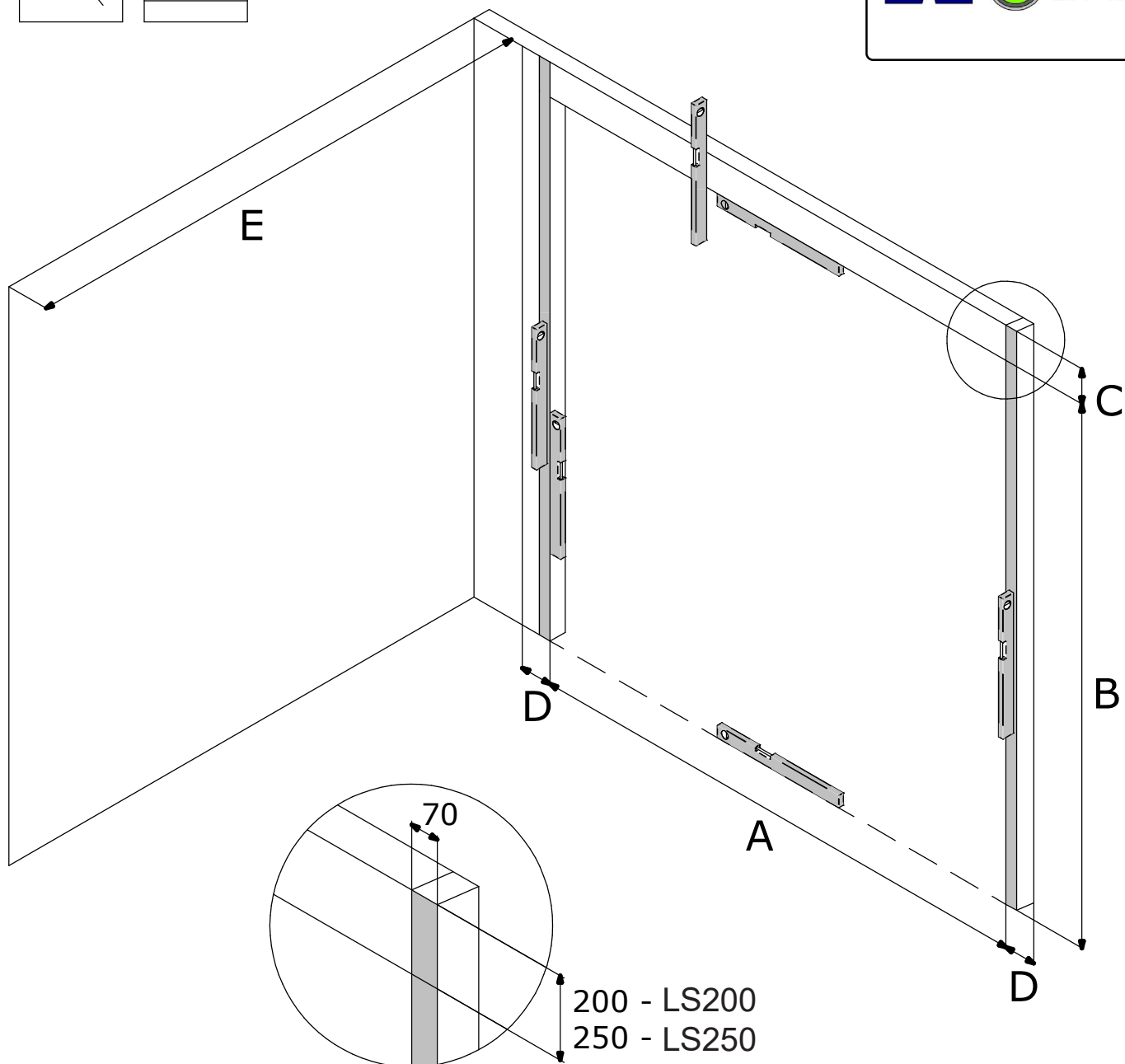

REA200 Manual

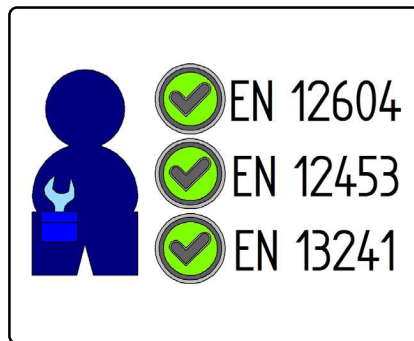
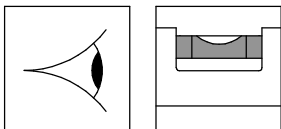

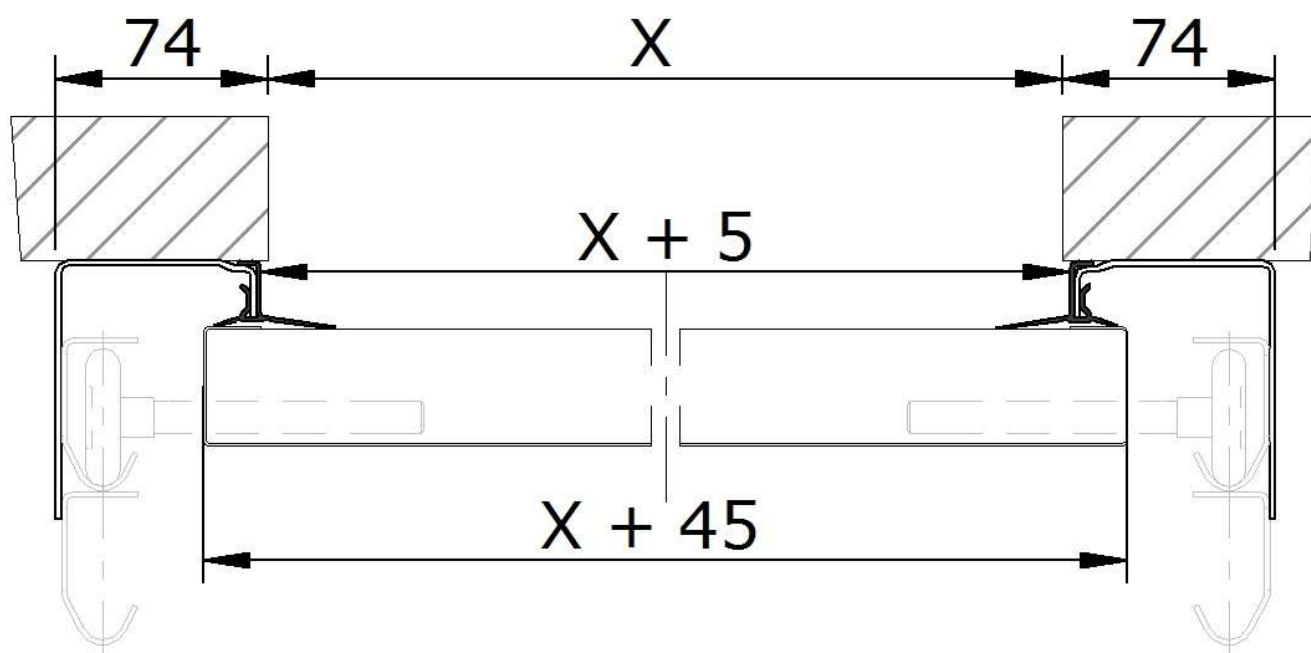
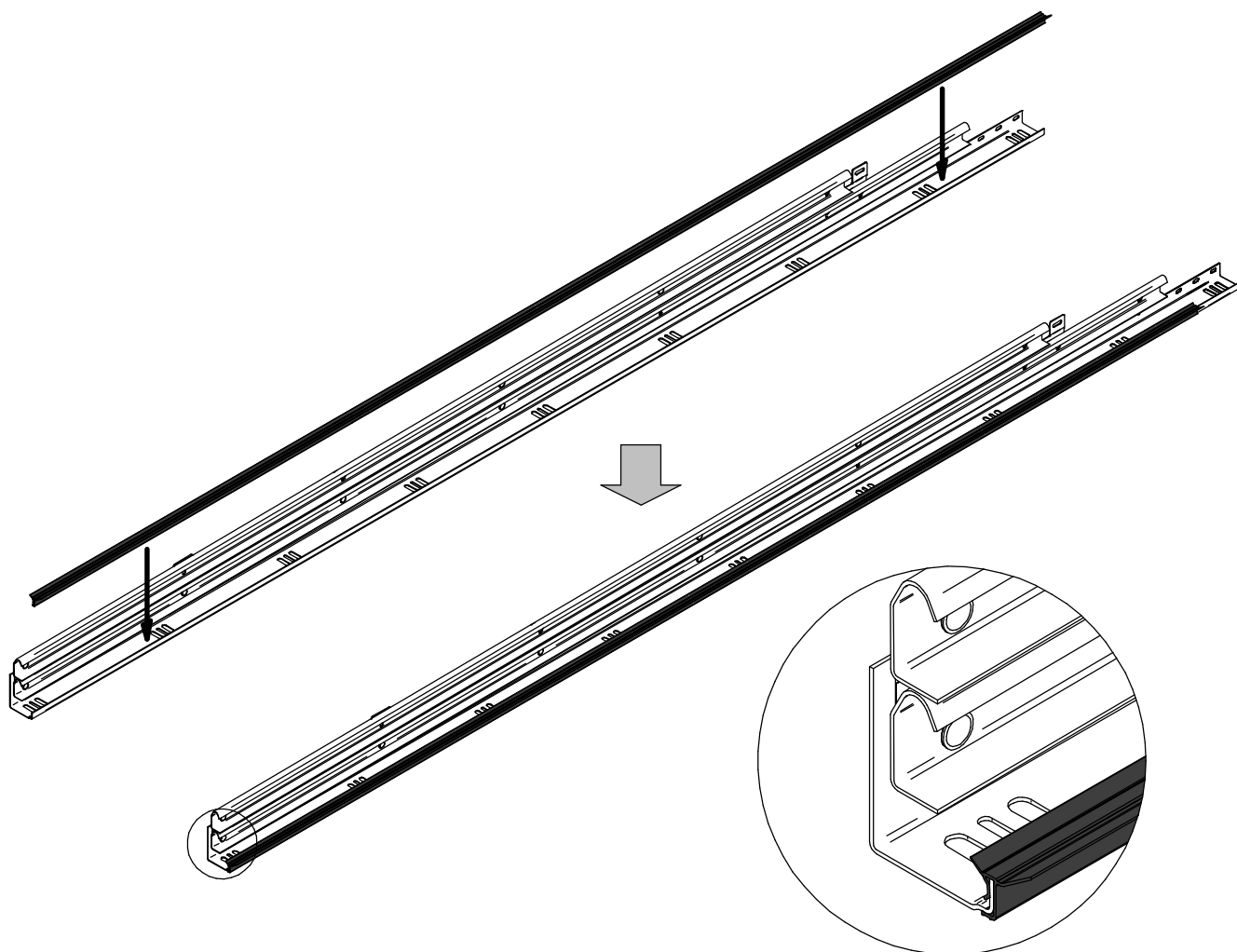

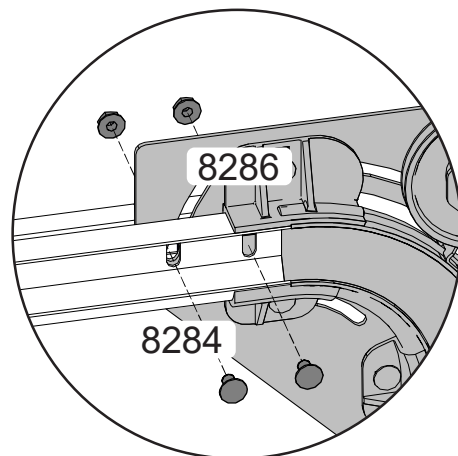
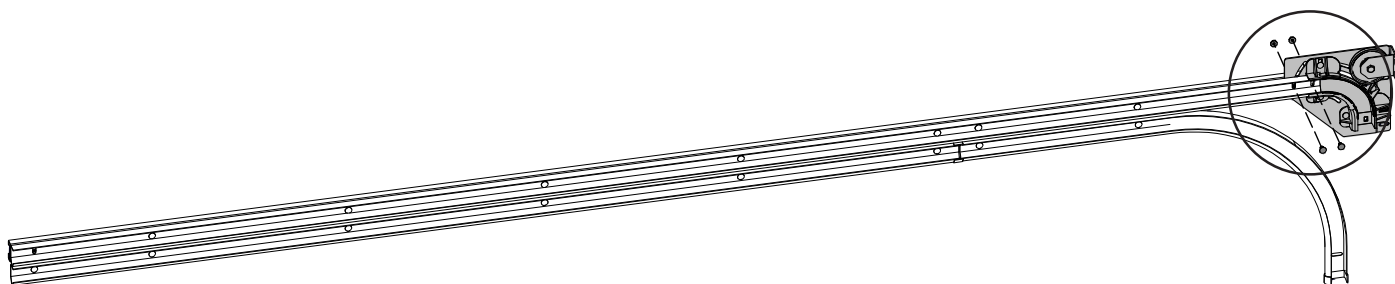
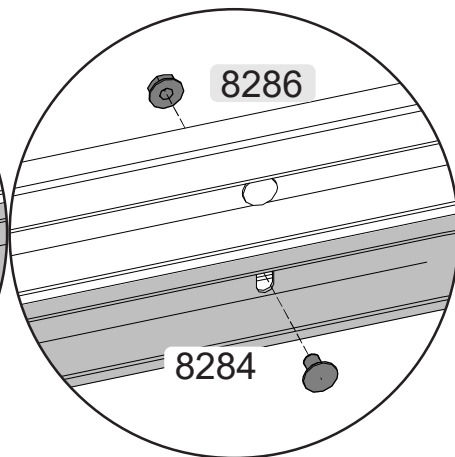
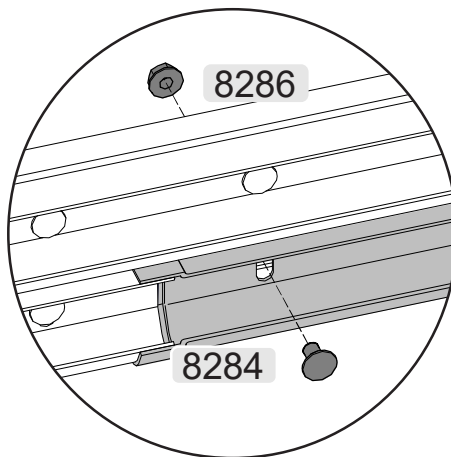
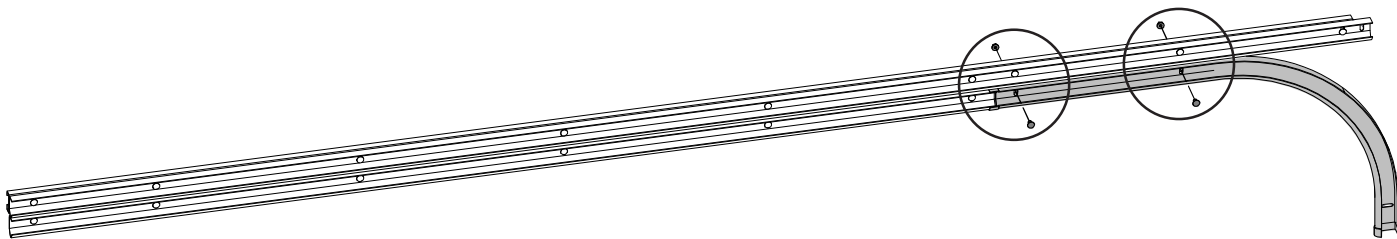

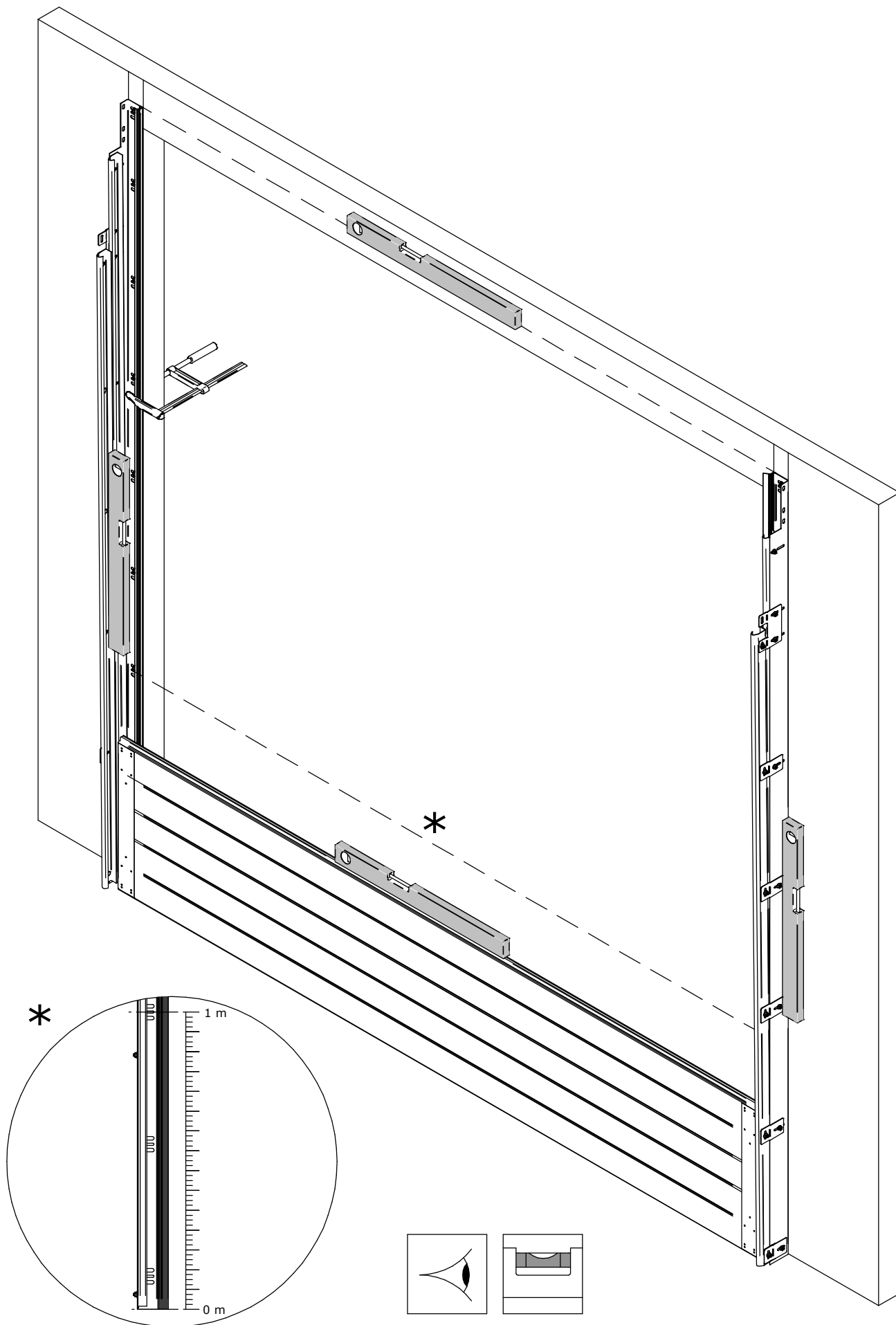

0351



8011



8010

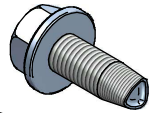

Ø10

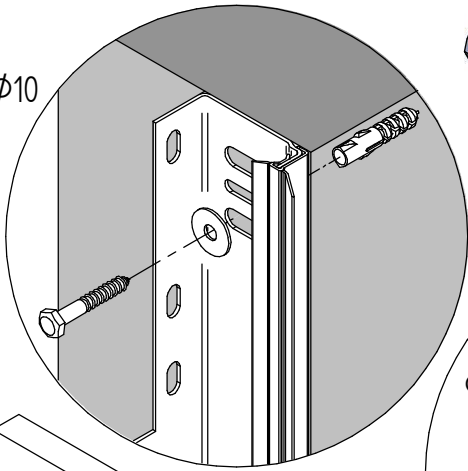

Ø6

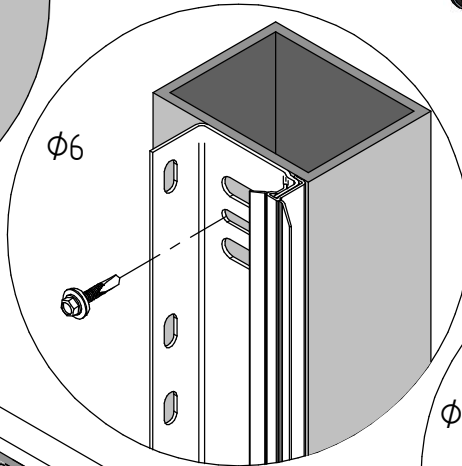

Ø8

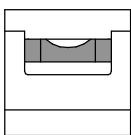
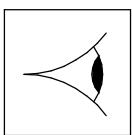
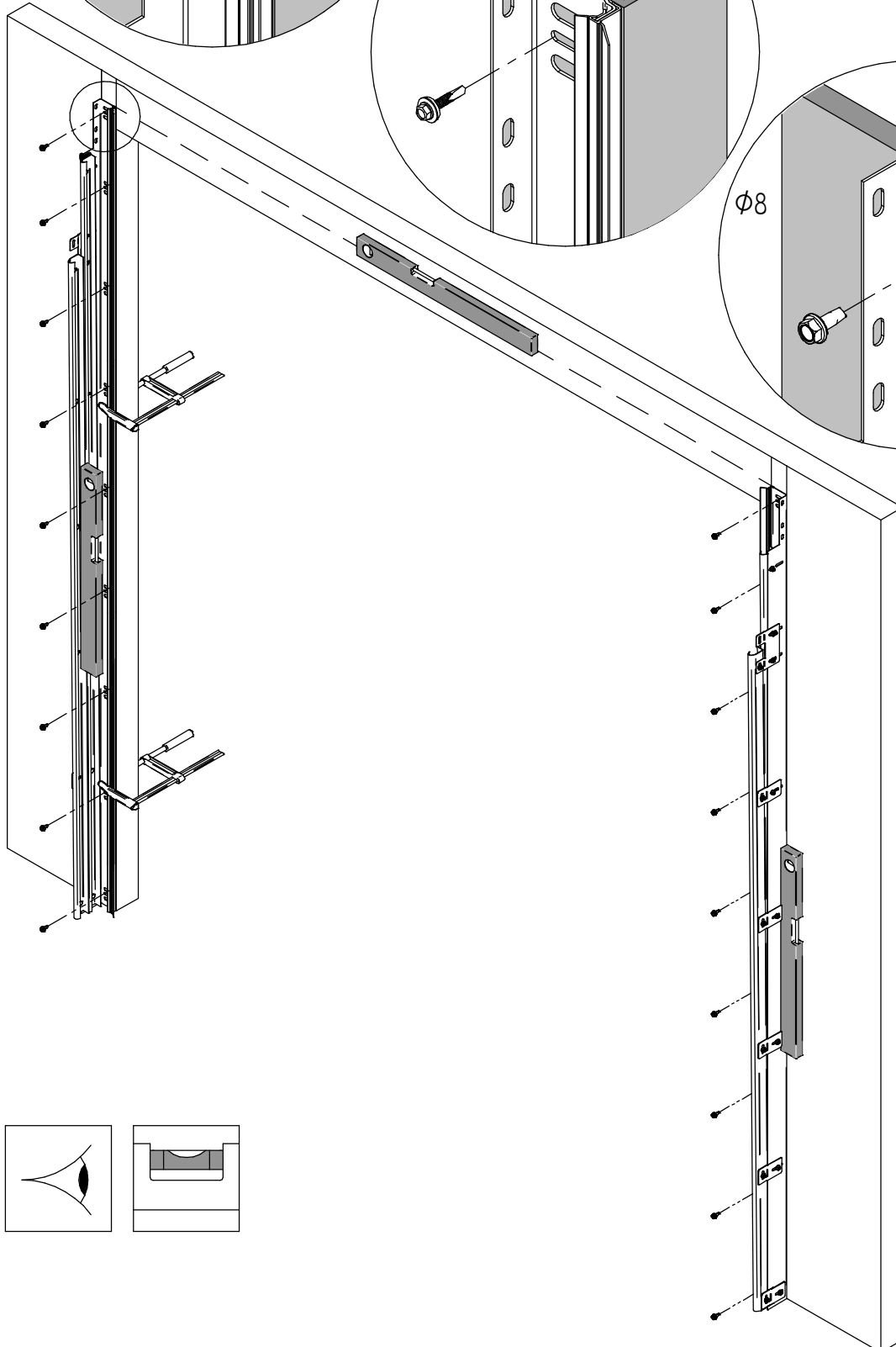
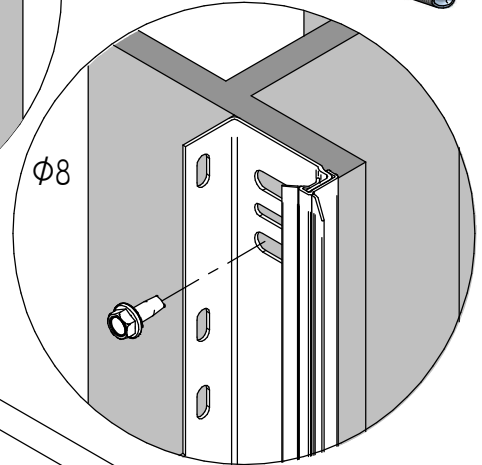

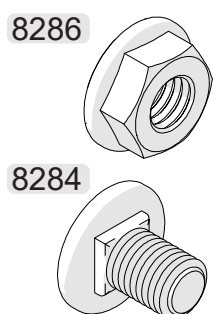
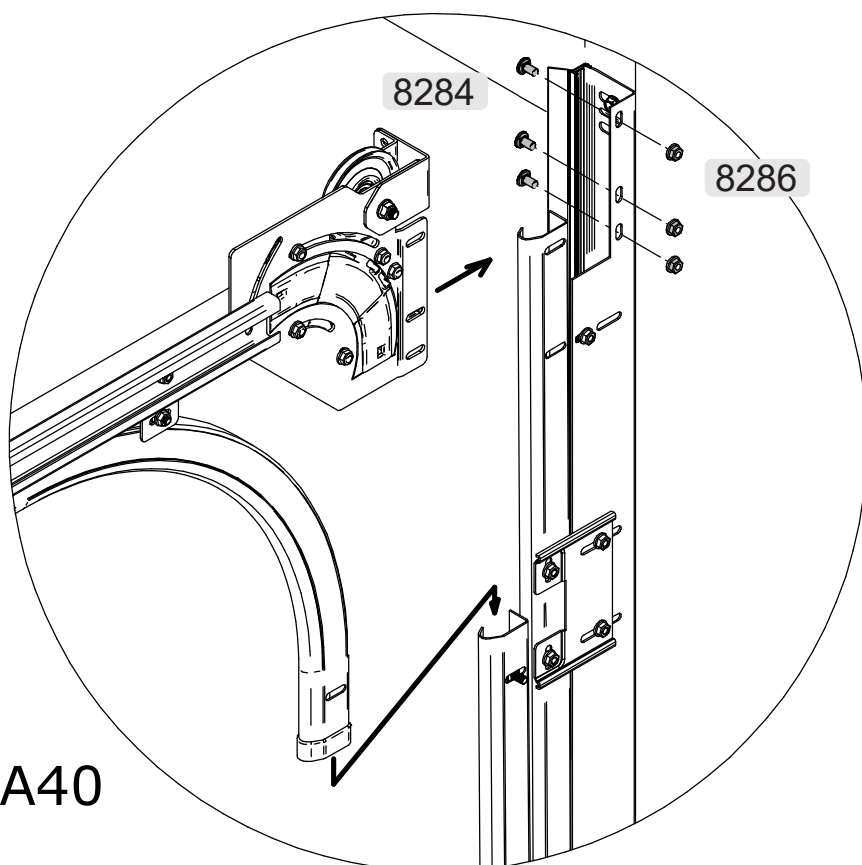
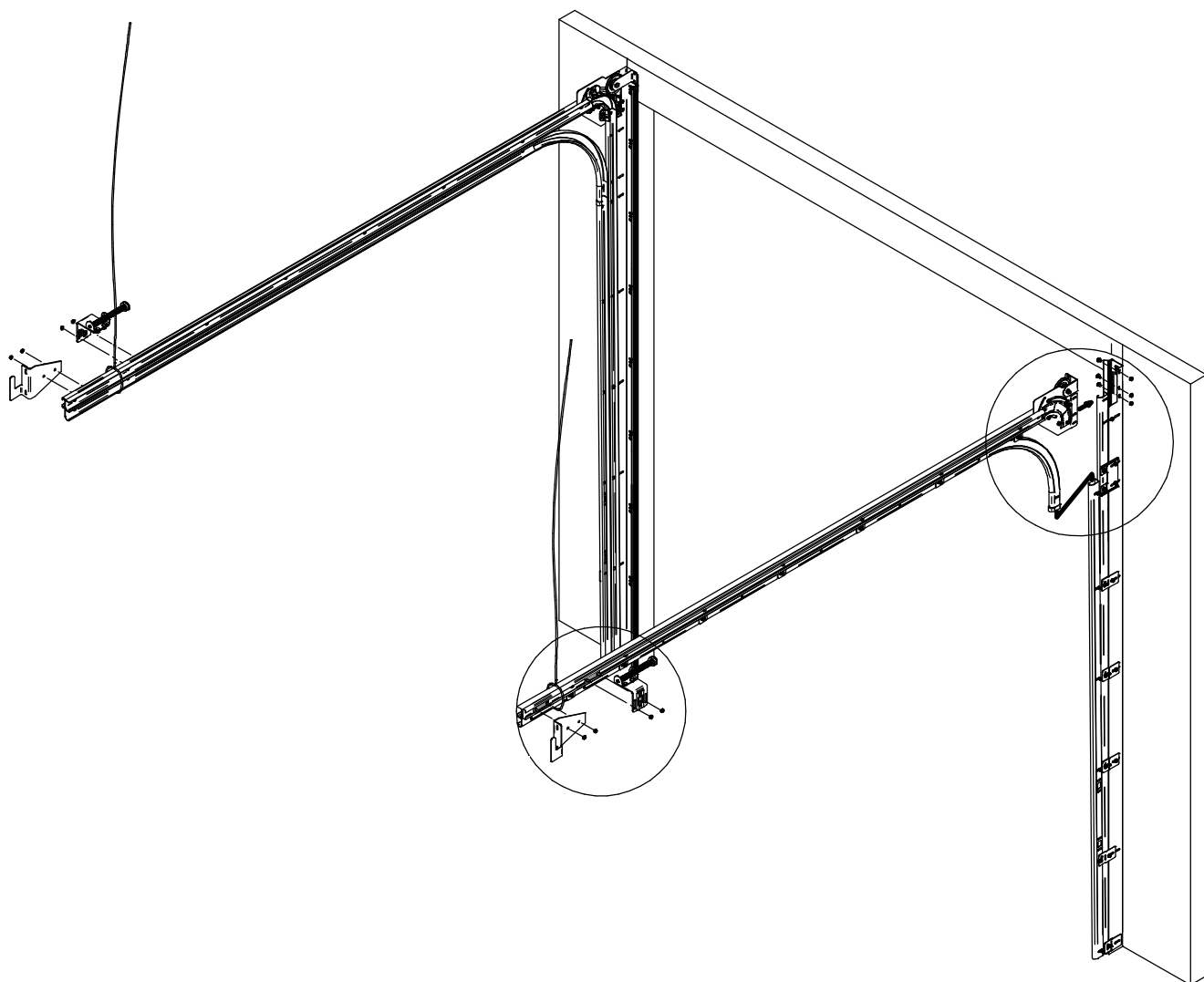

S40/ A40

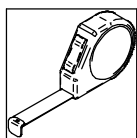
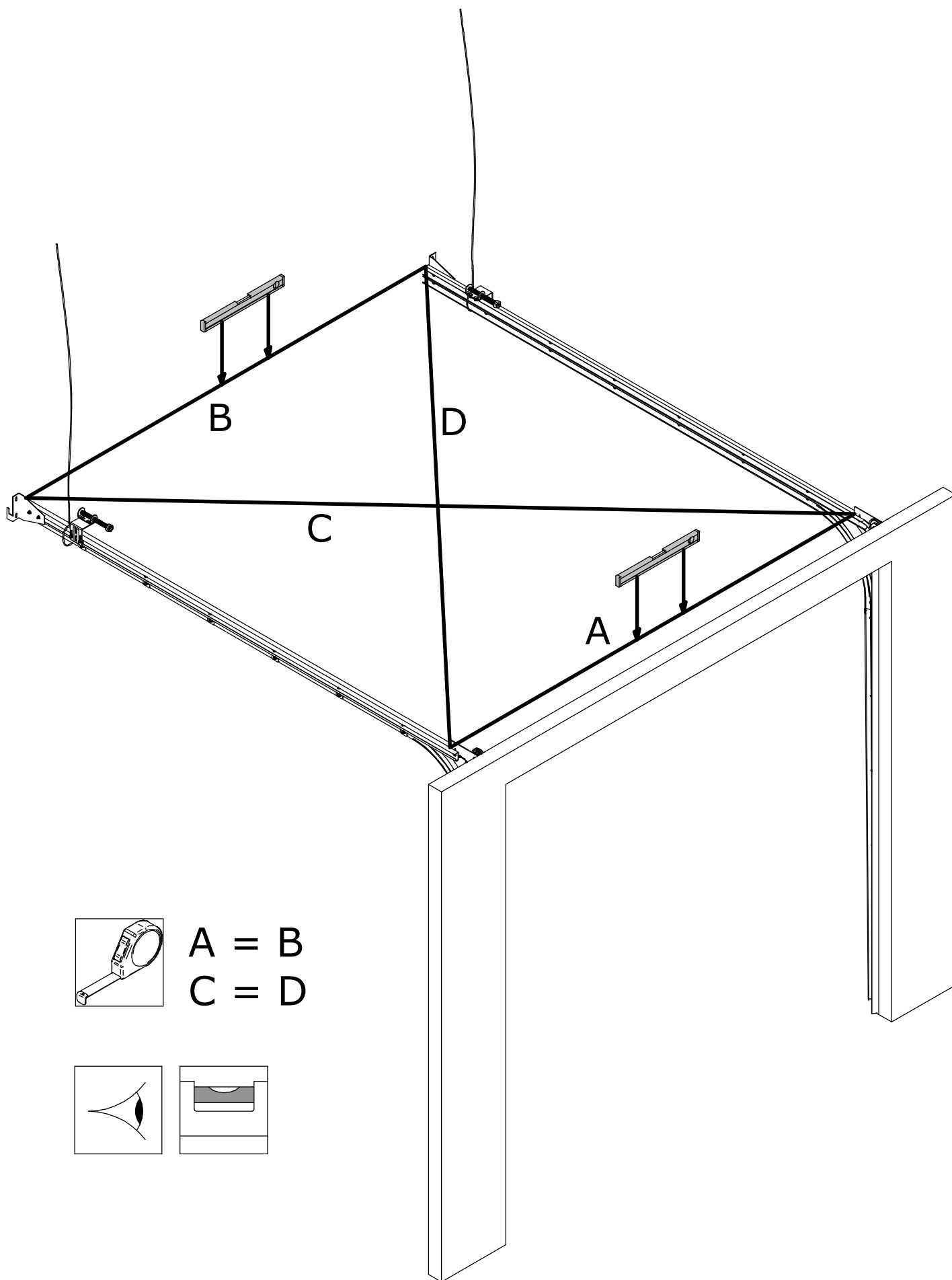

$$A = B$$

$$C = D$$

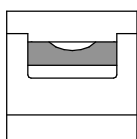
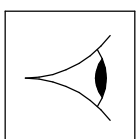



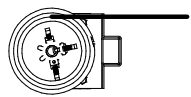
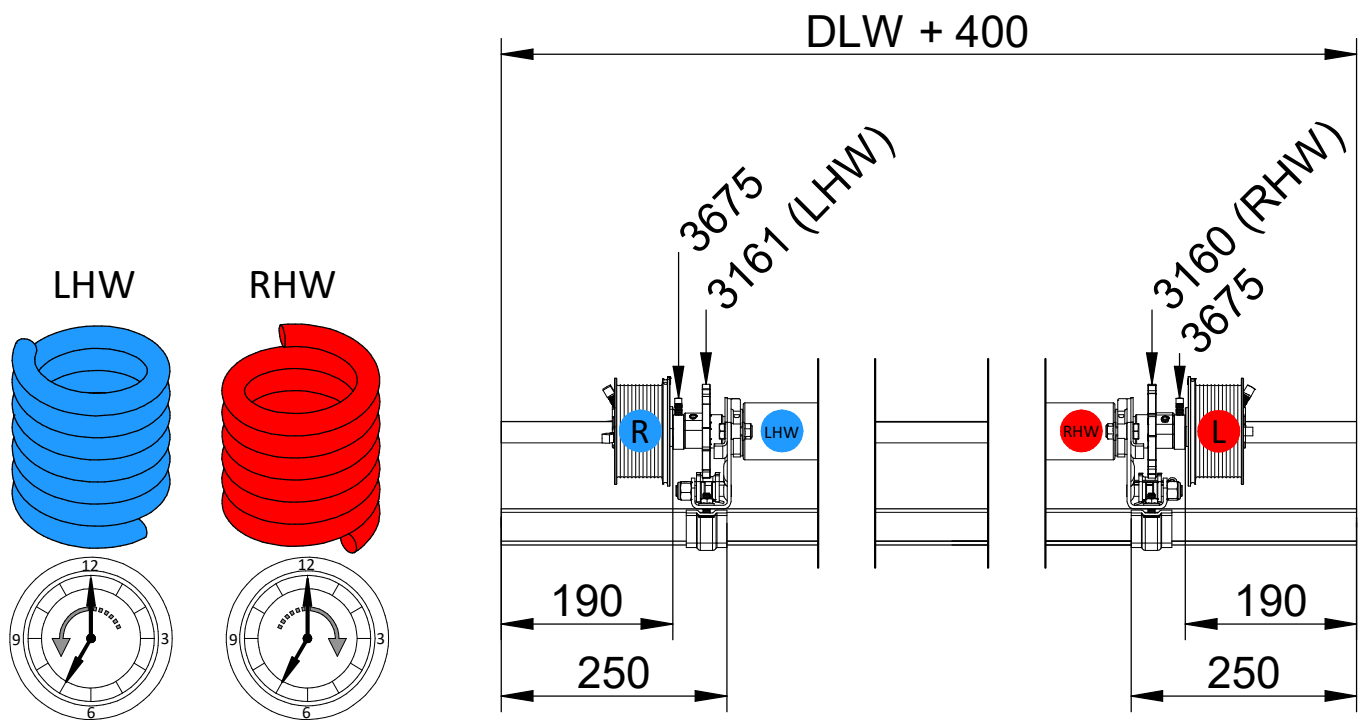

LS200 /  
250



HAND  
CONTROL

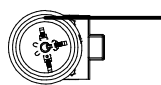
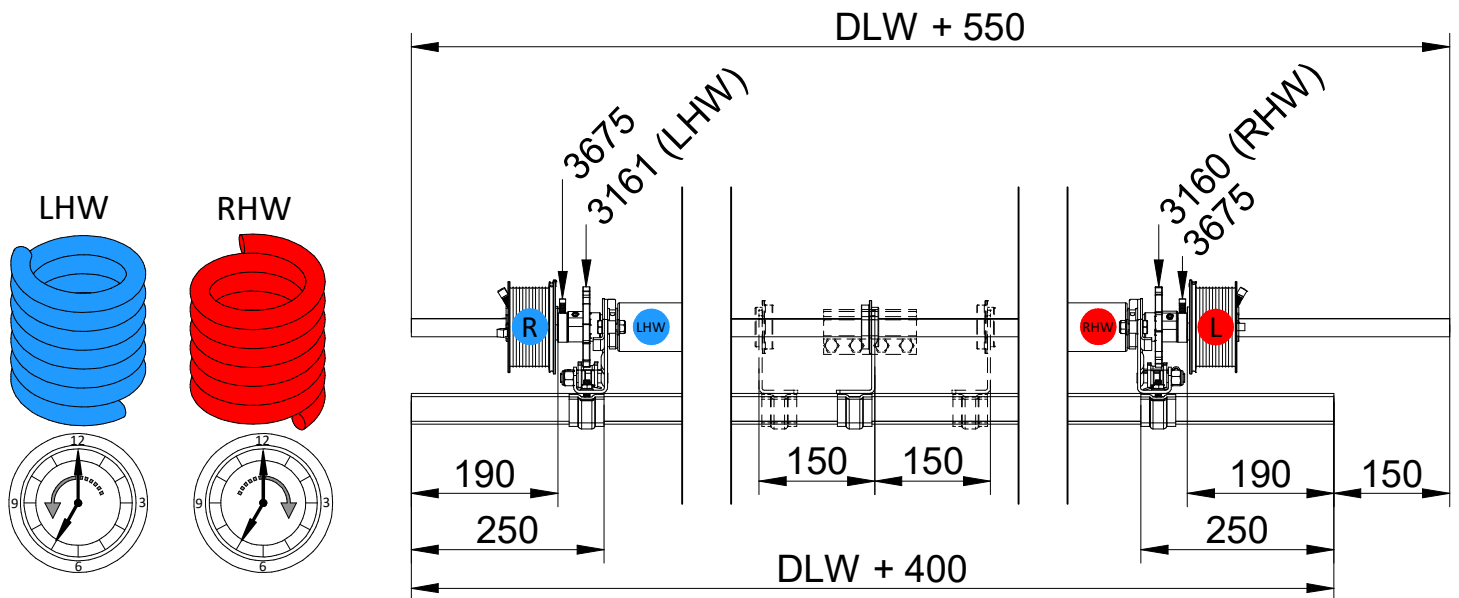

LS200 /  
250

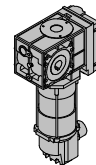

MOTOR  
CONTROL  
RIGHT

# LS200

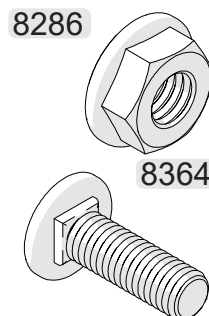
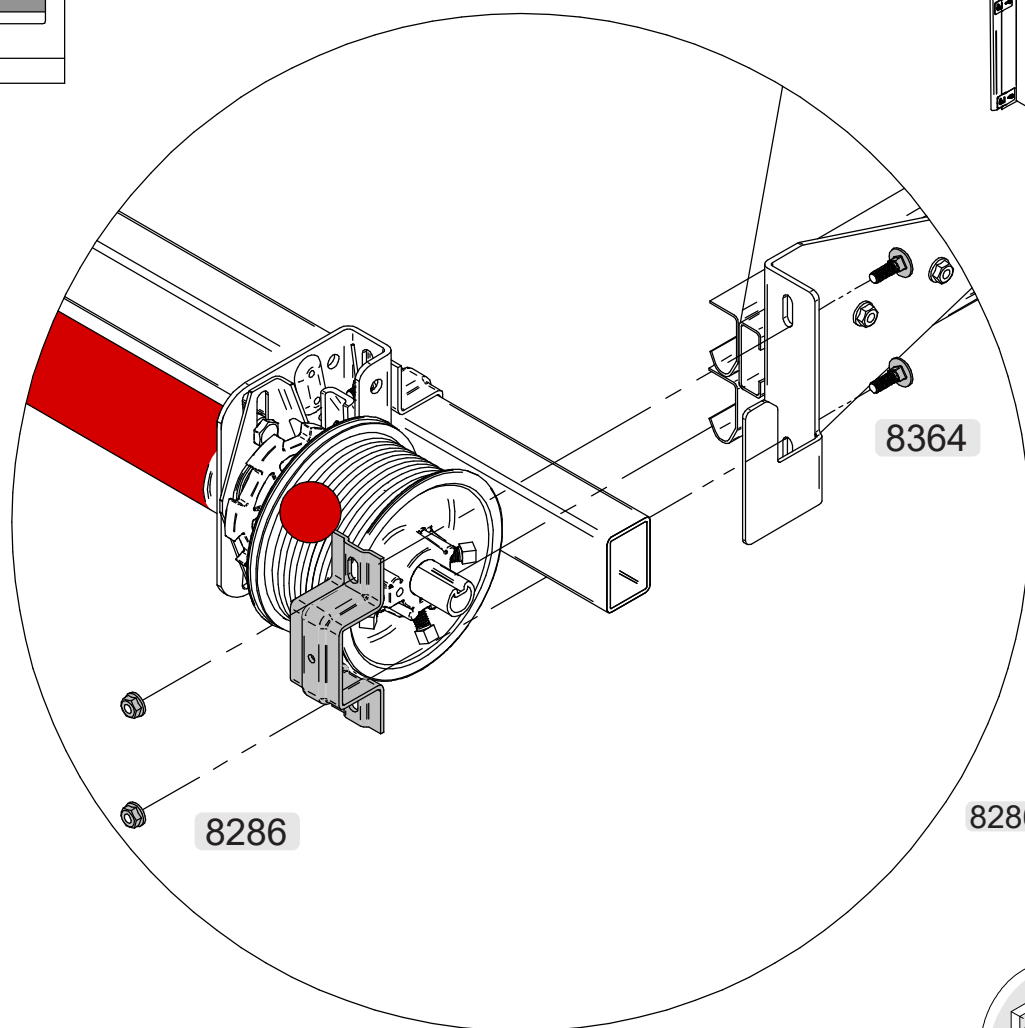
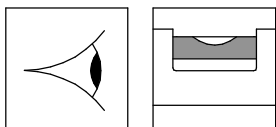
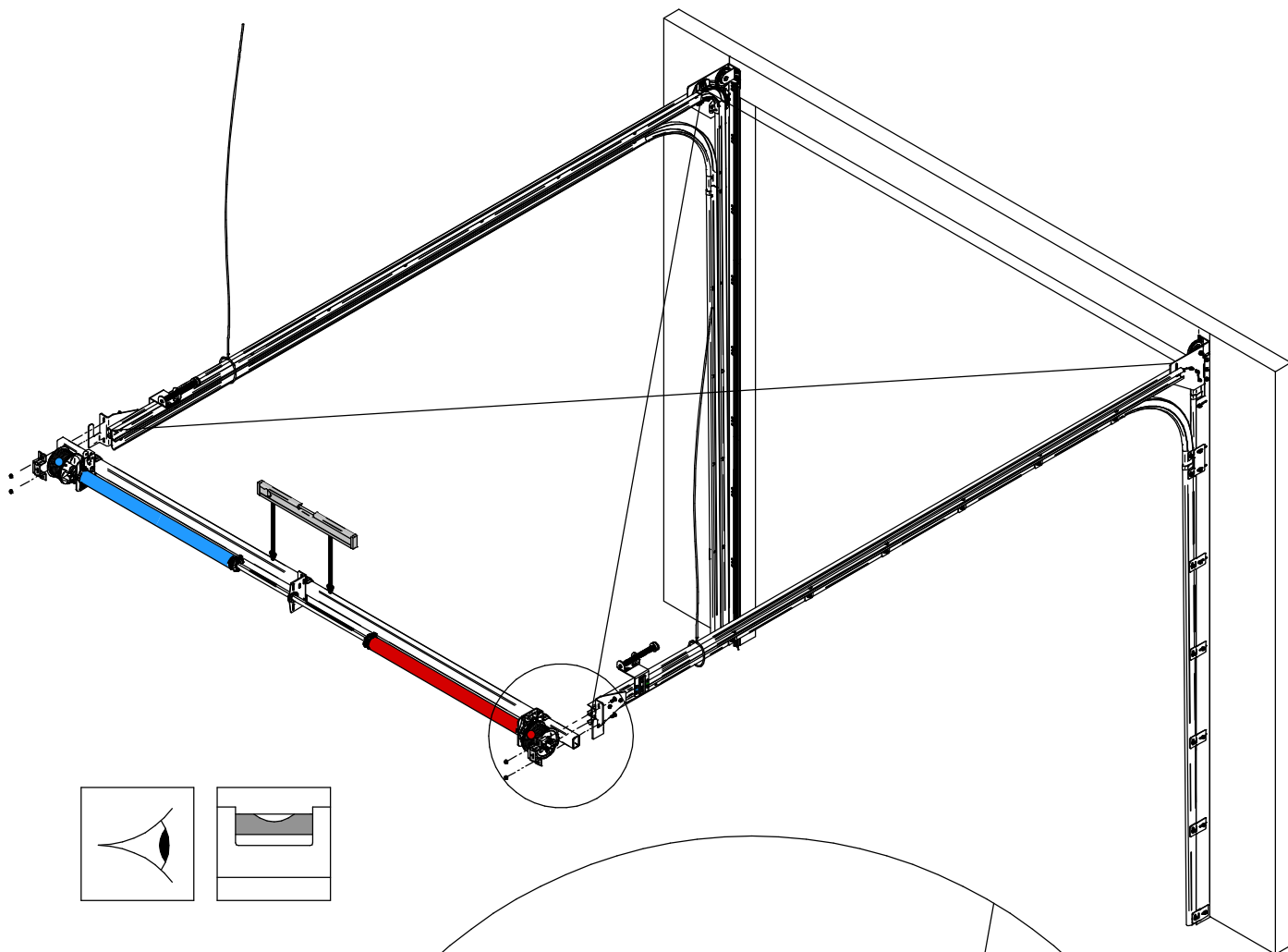

# LS250

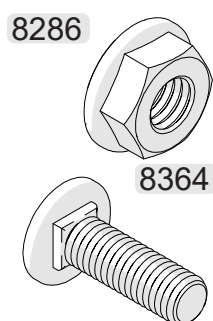
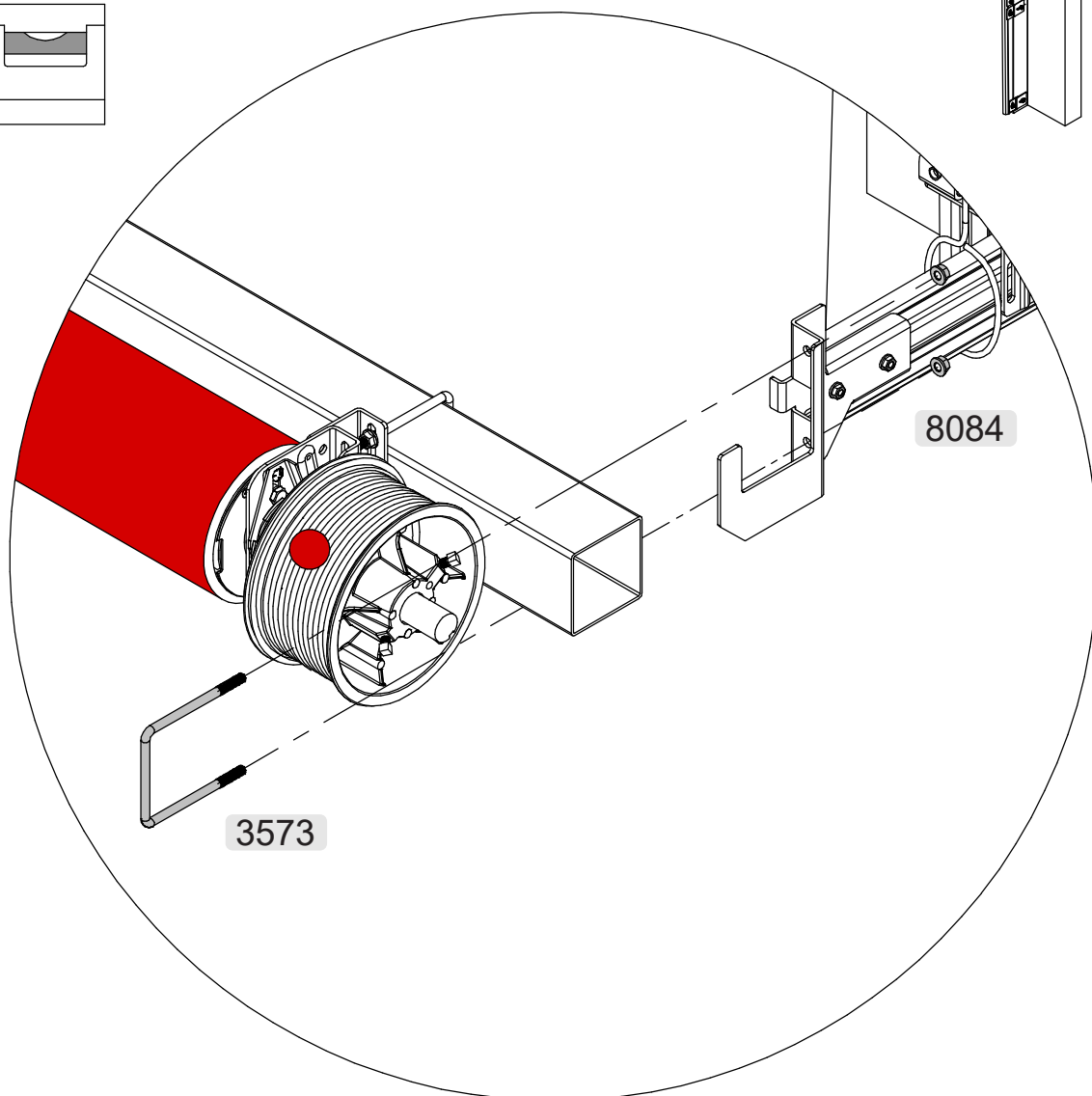
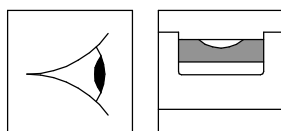
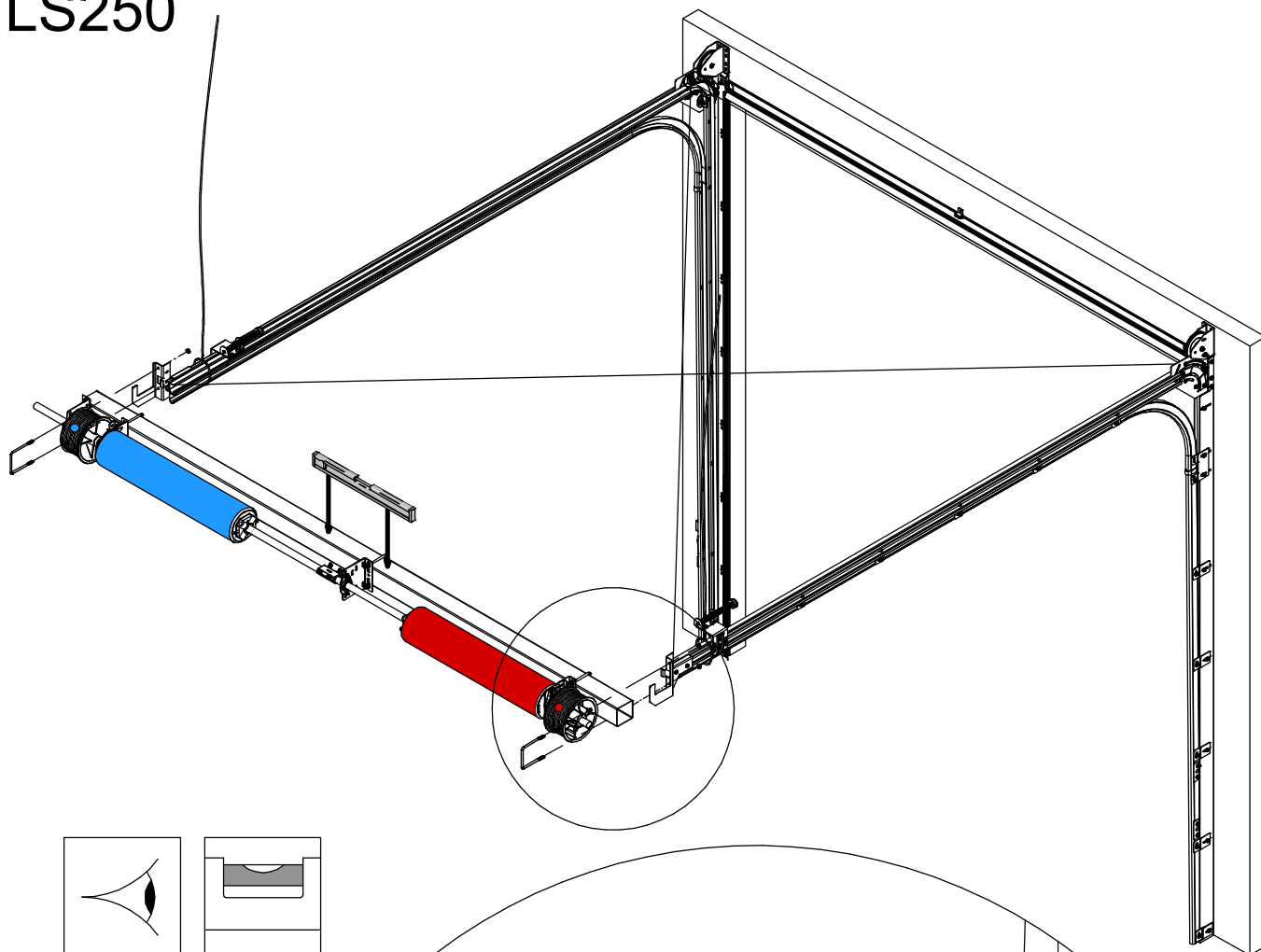

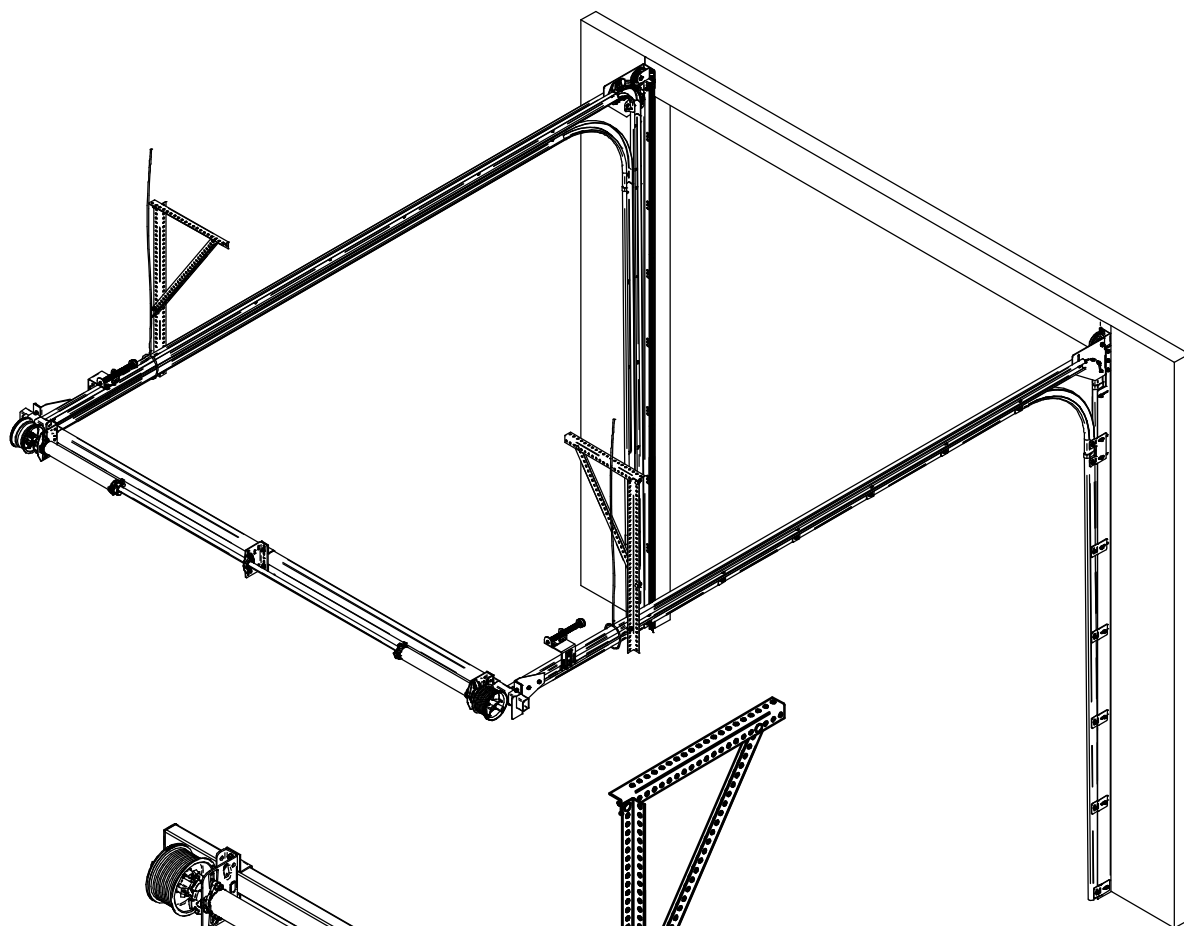

DMB > 3999 mm

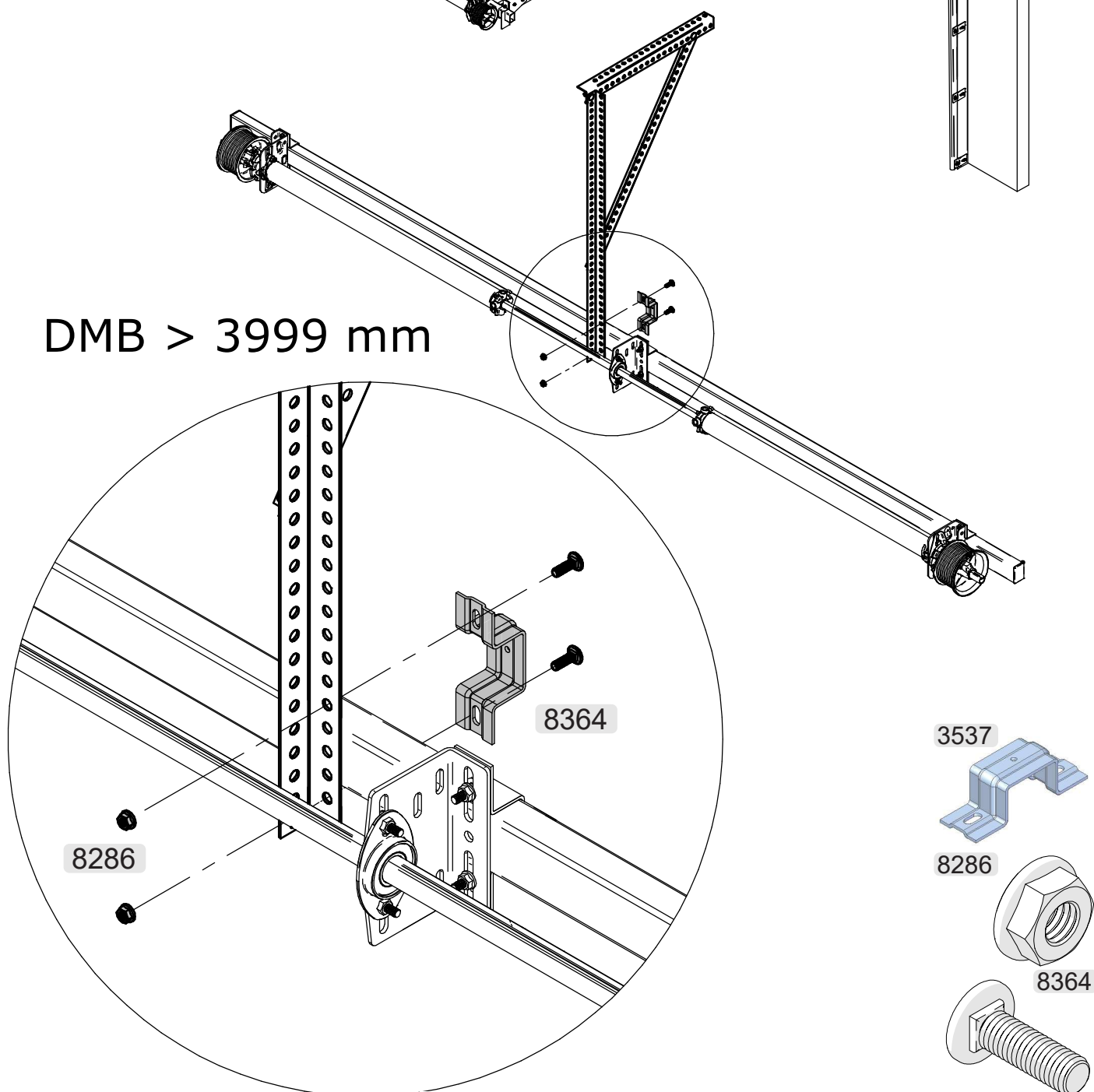

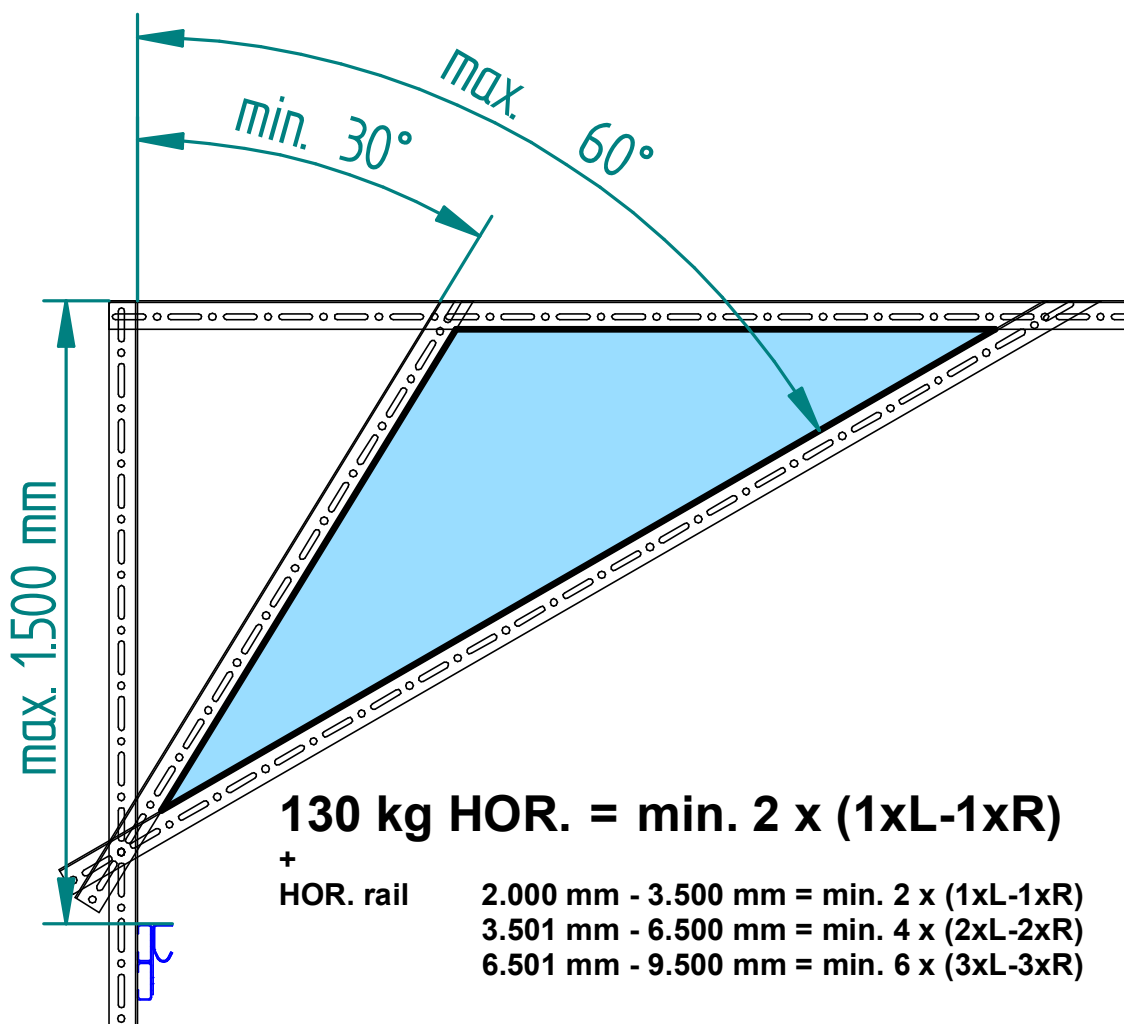
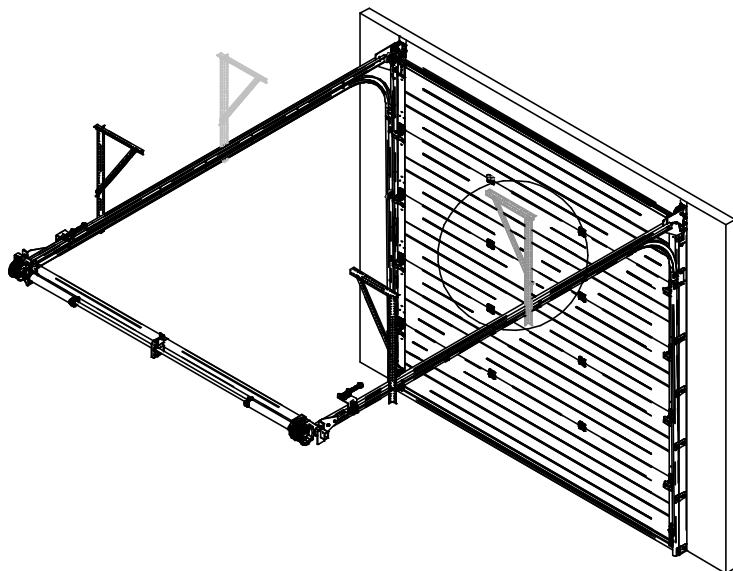
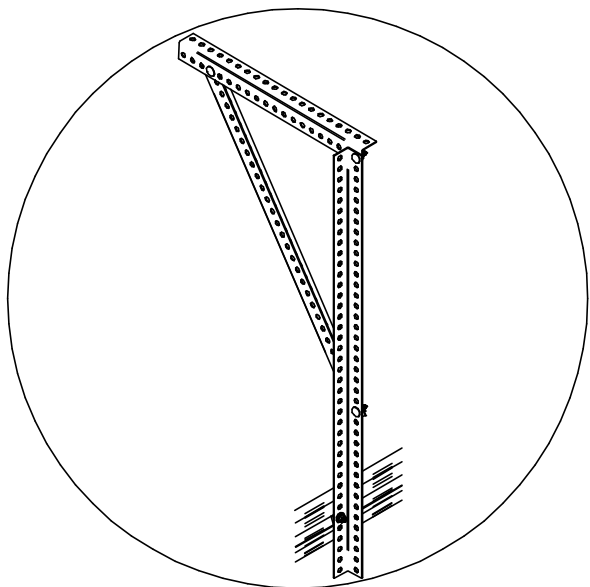

1

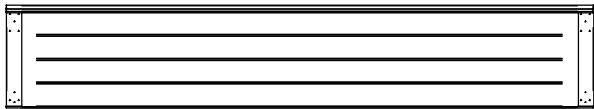

2

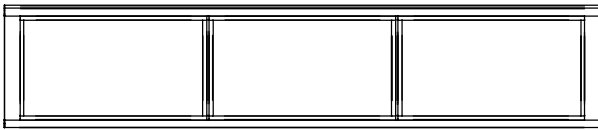

3

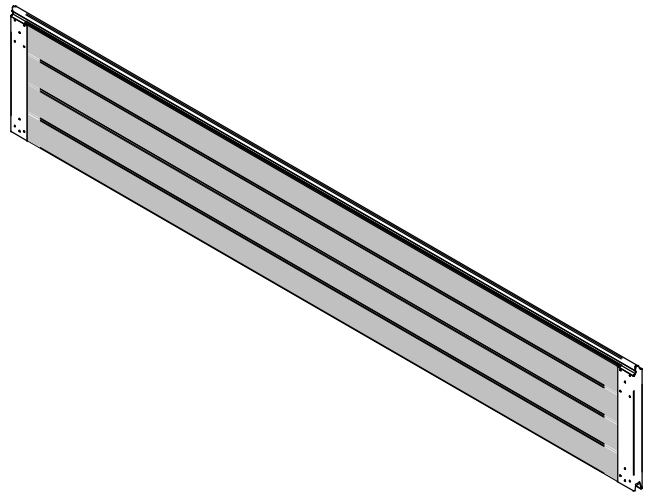
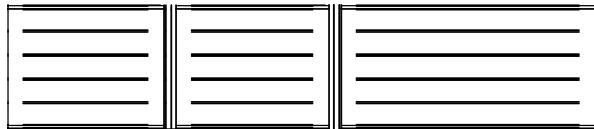

1

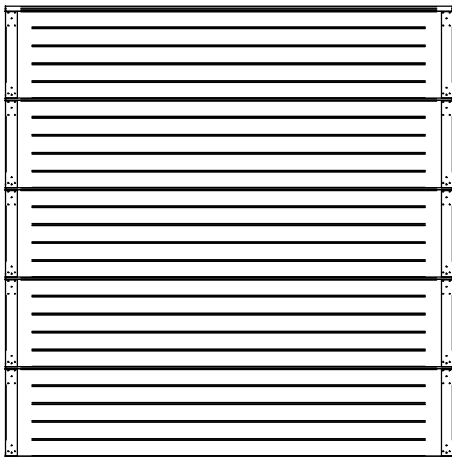

3

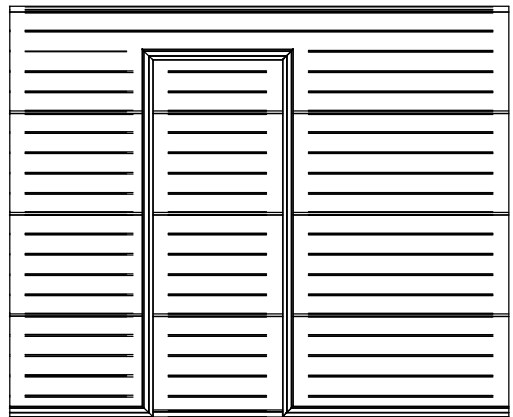

2

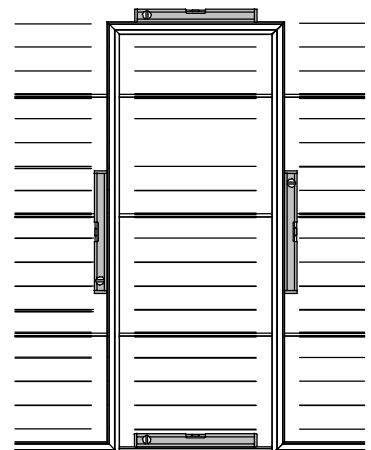
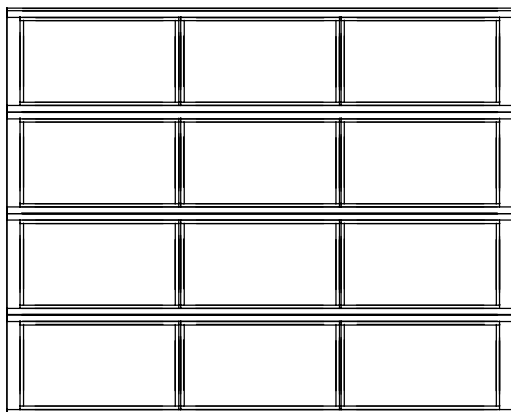

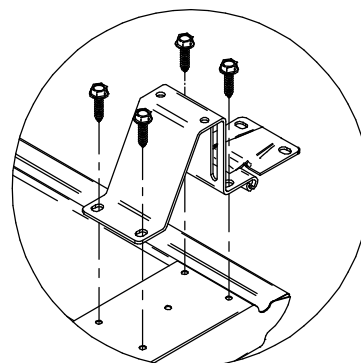
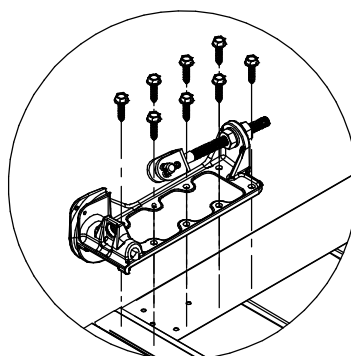
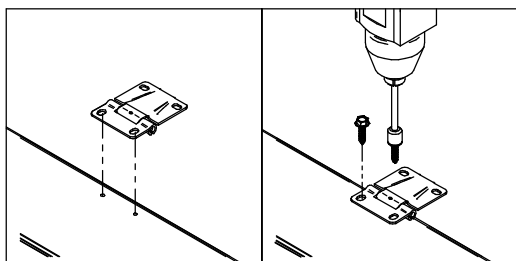
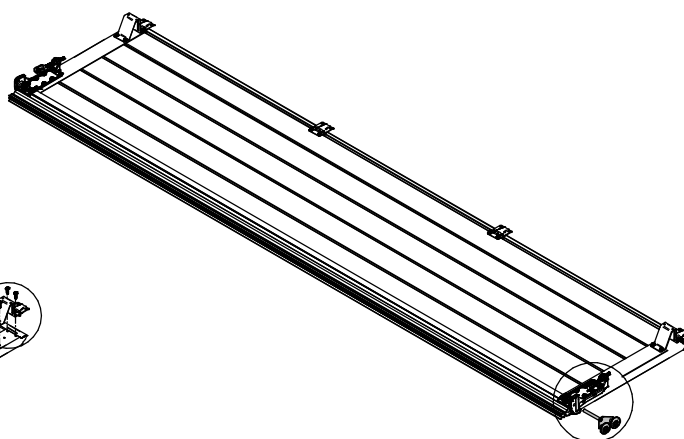
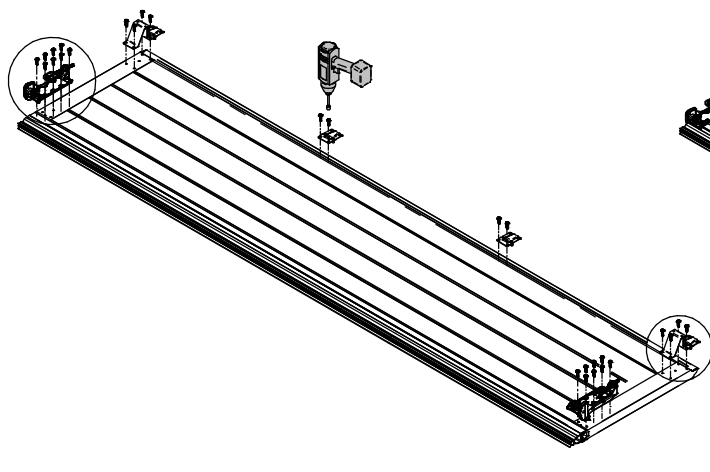
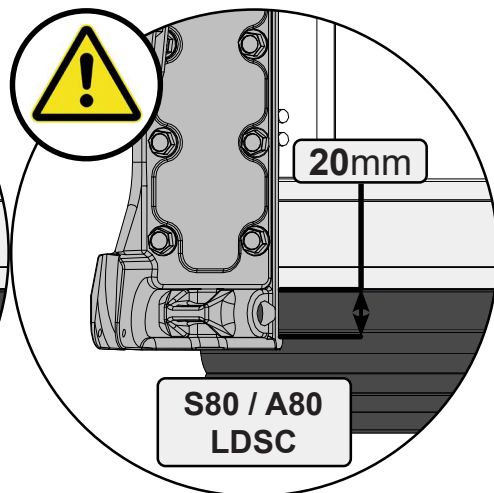
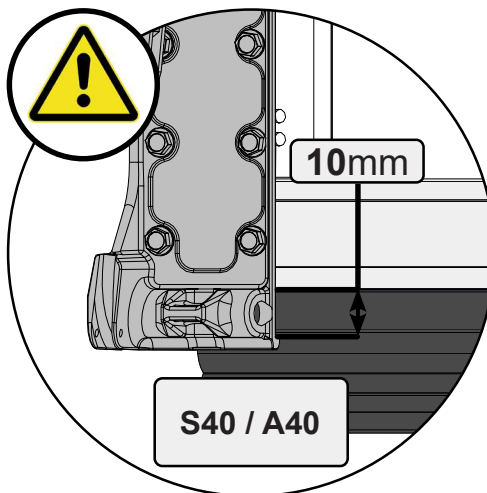
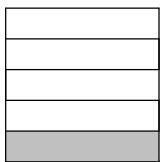

3170

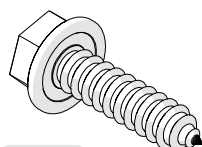
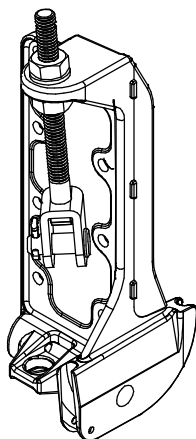

3812

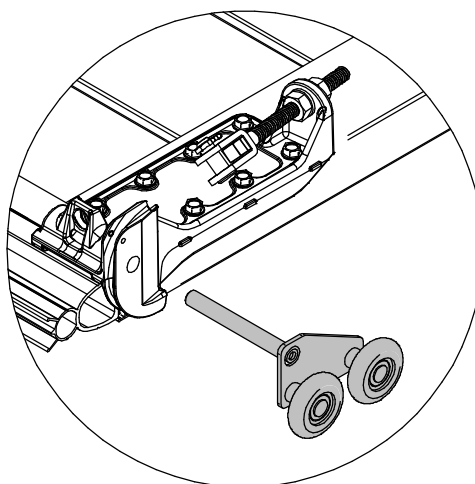

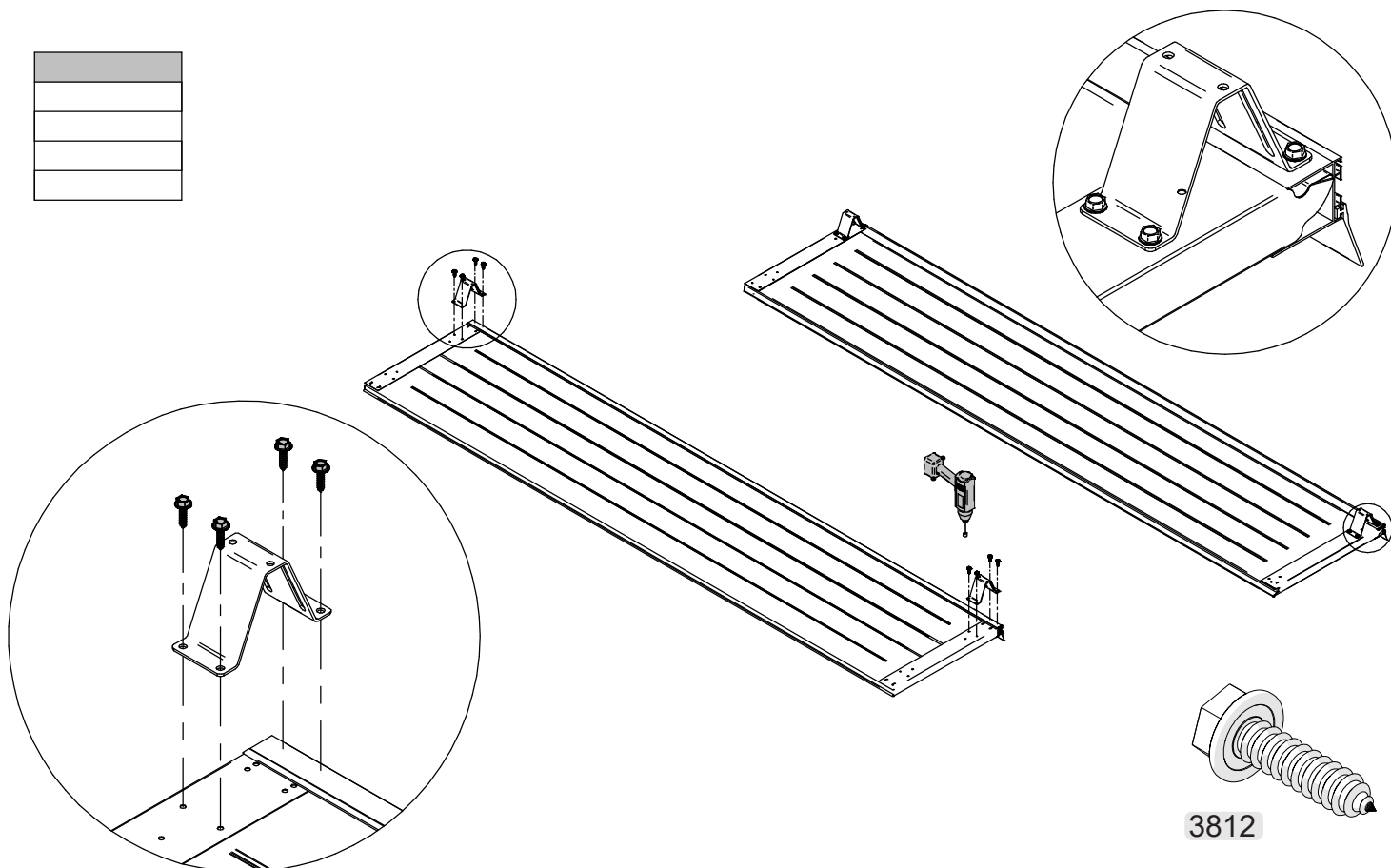
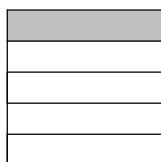
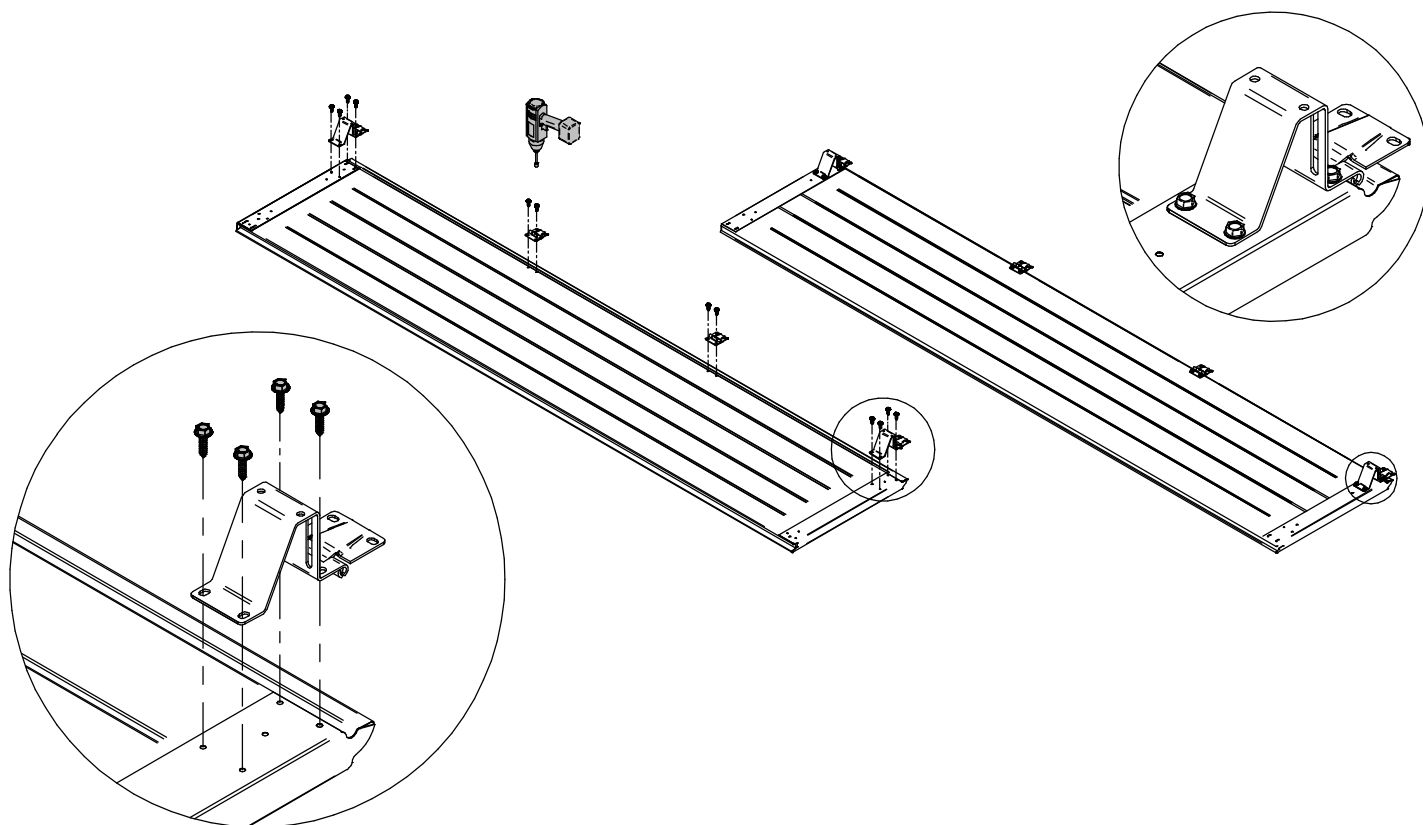
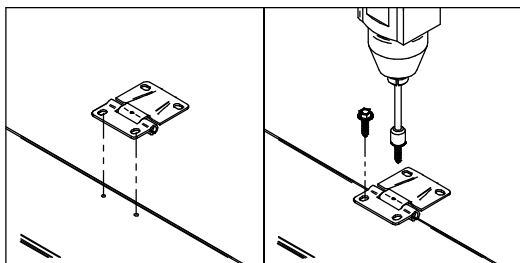
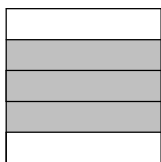



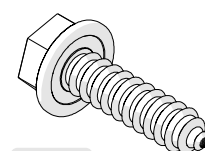
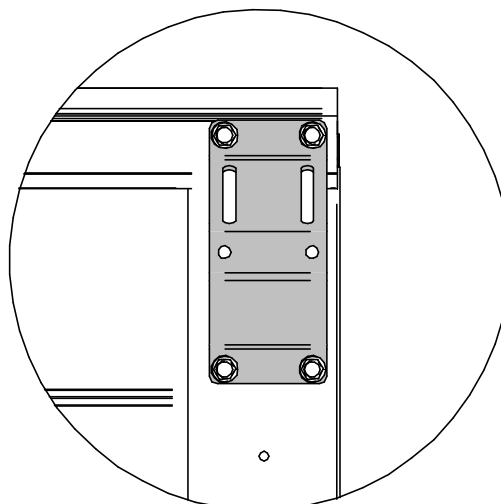
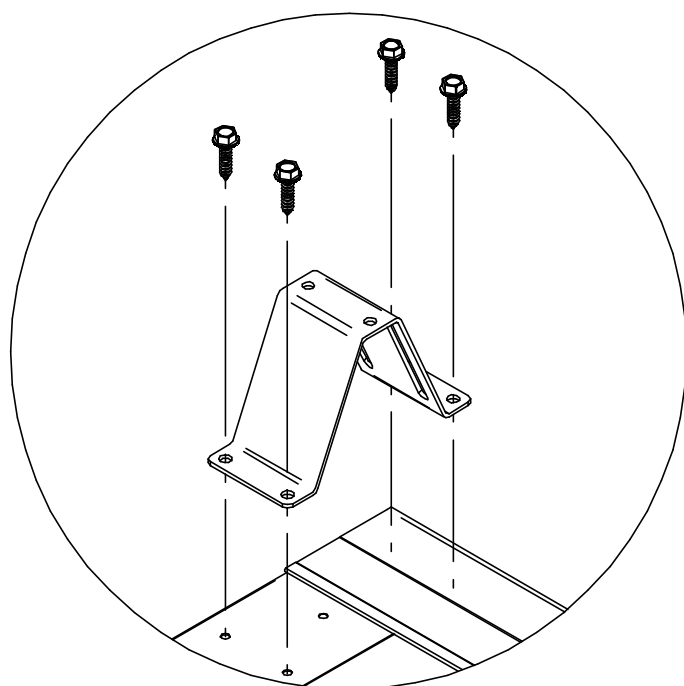
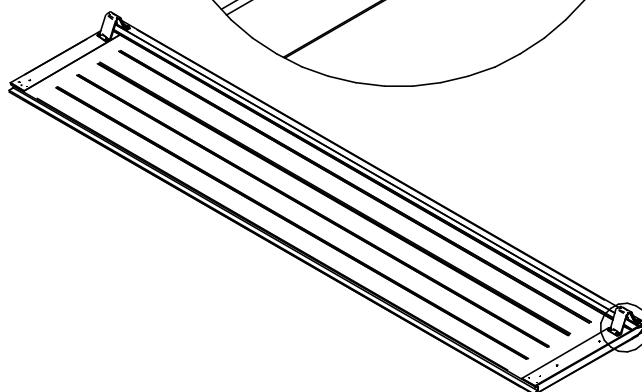
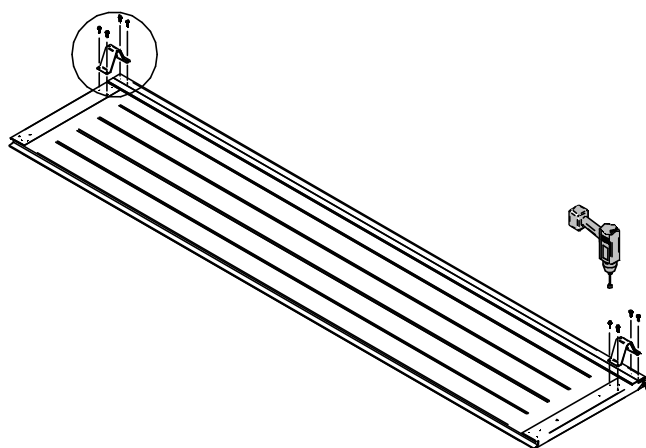
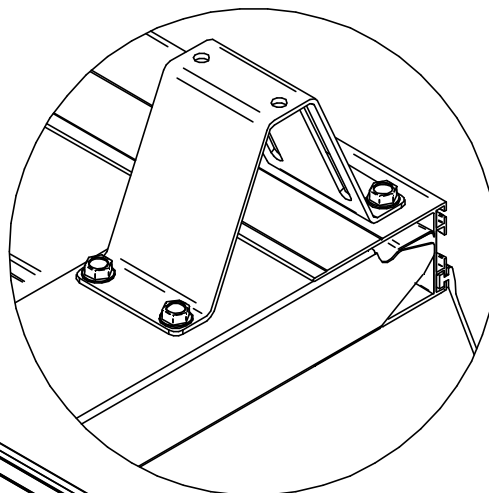
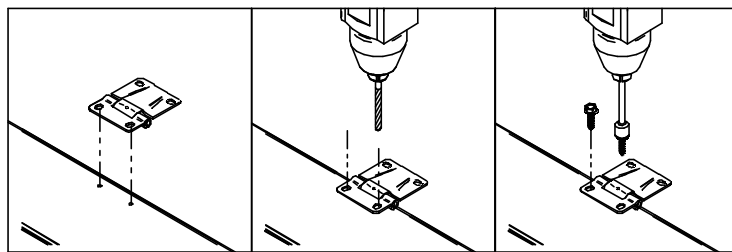
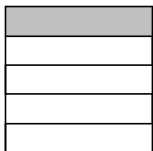

3812

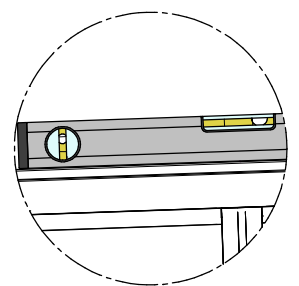
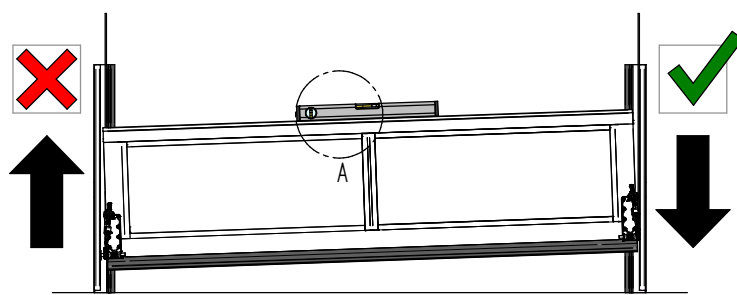
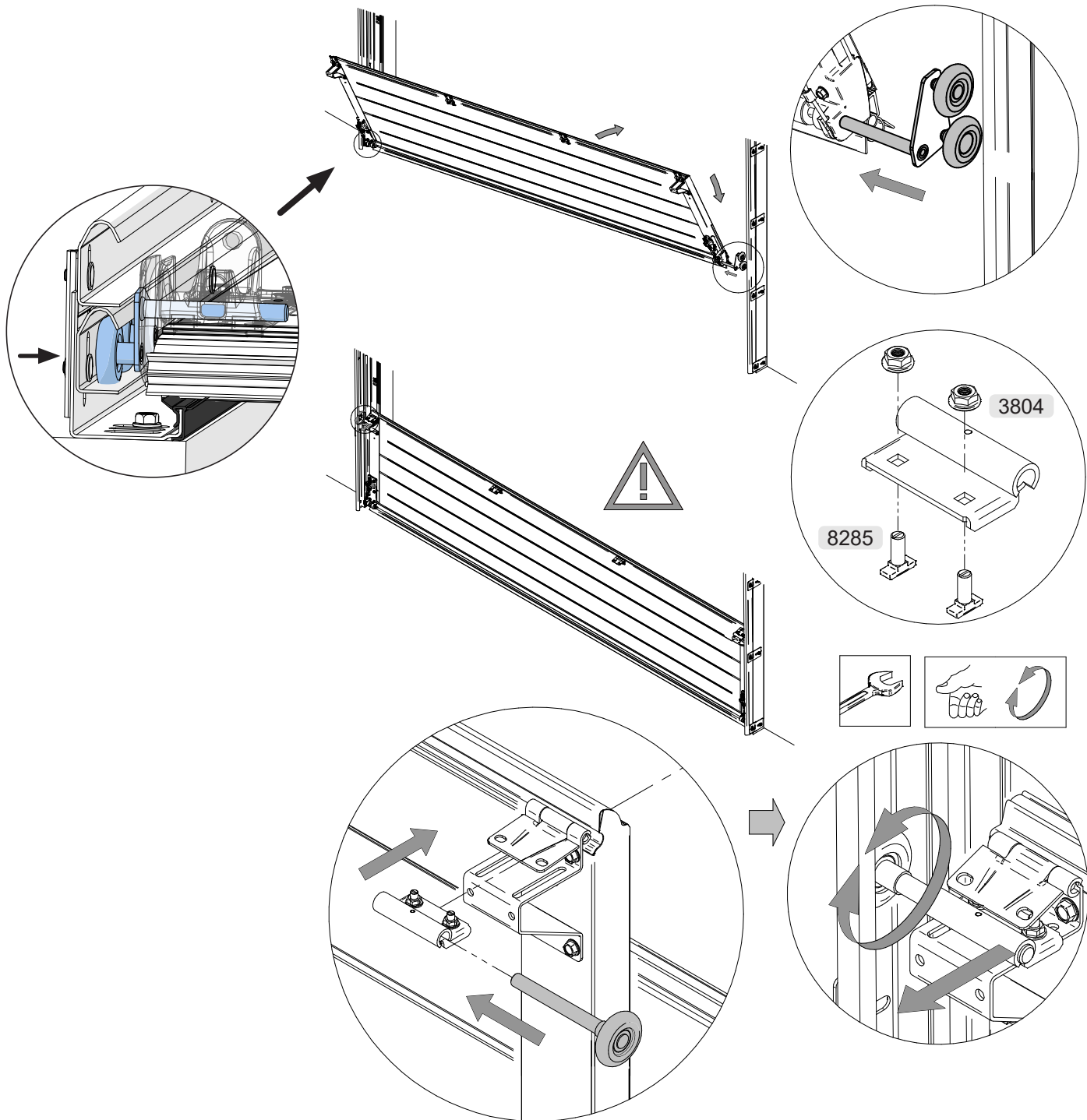

DETAIL A

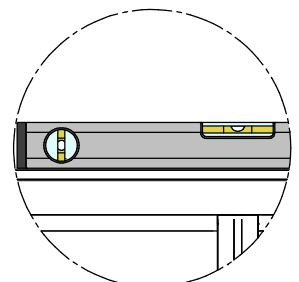
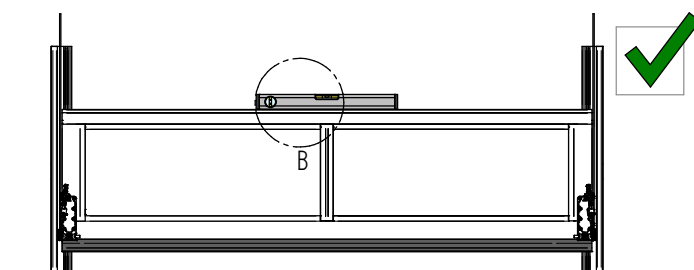

DETAIL B

3804

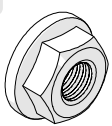

8284

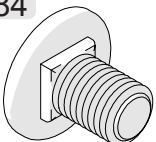

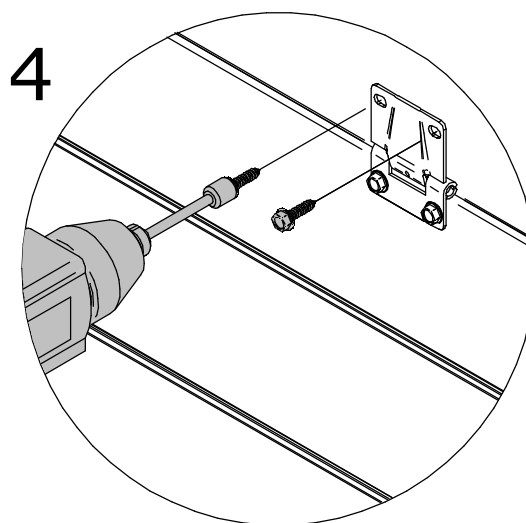
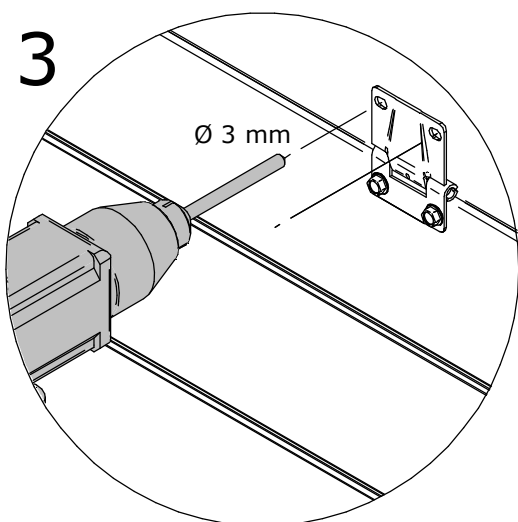
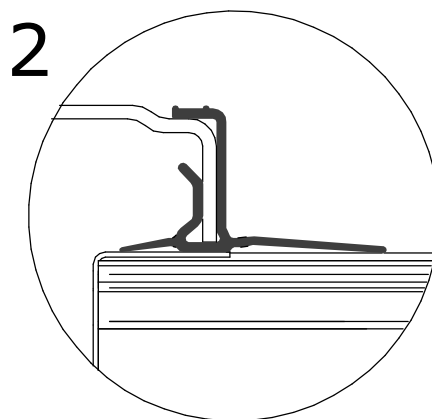
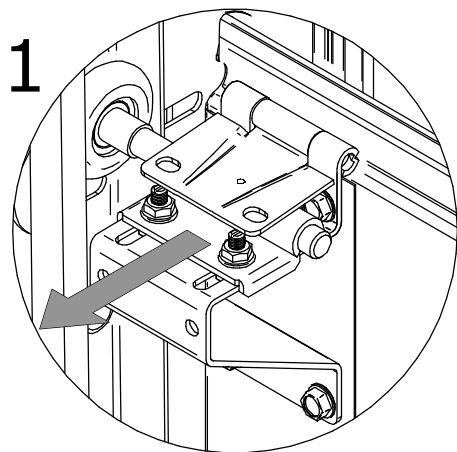
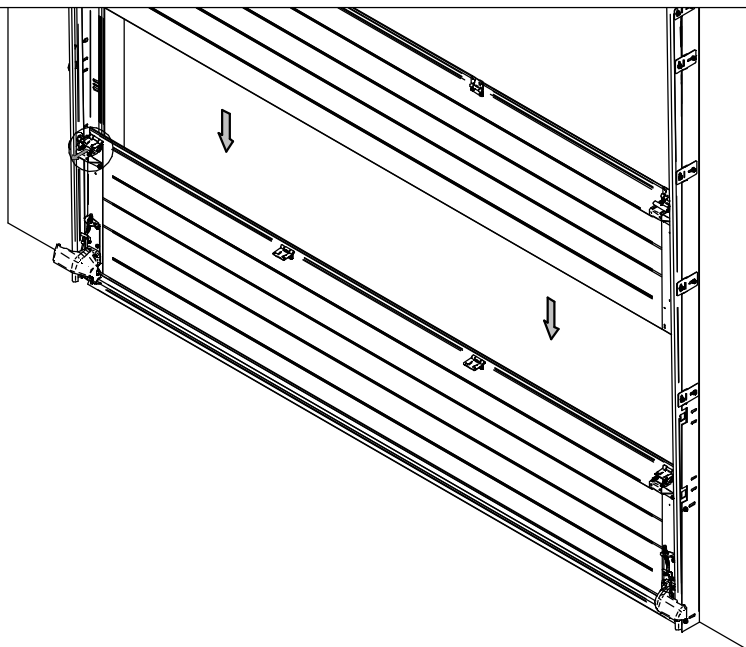
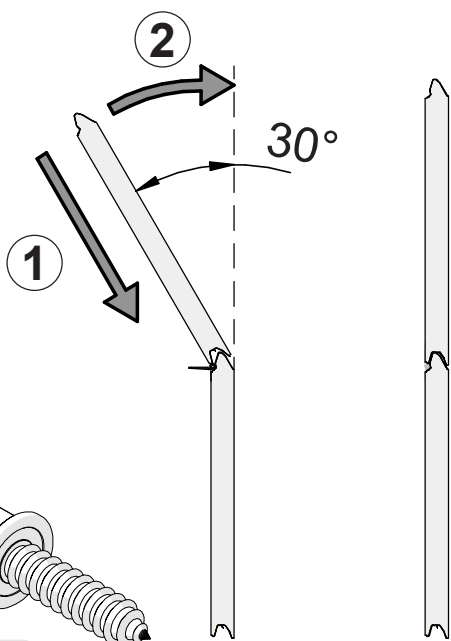

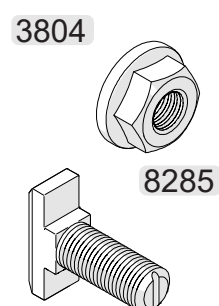
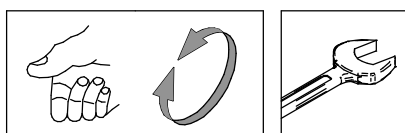
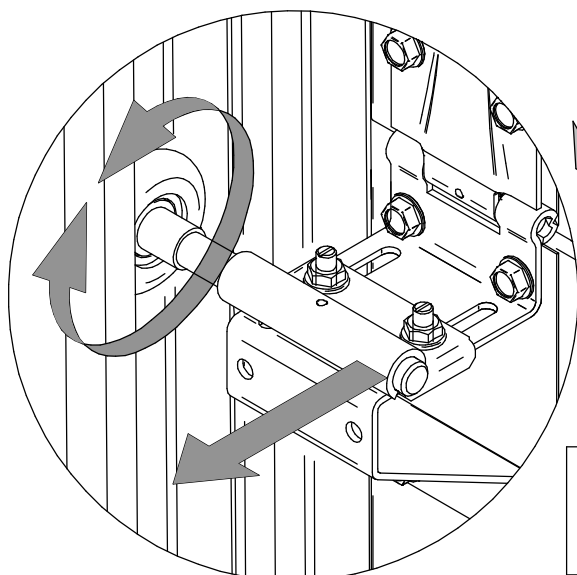
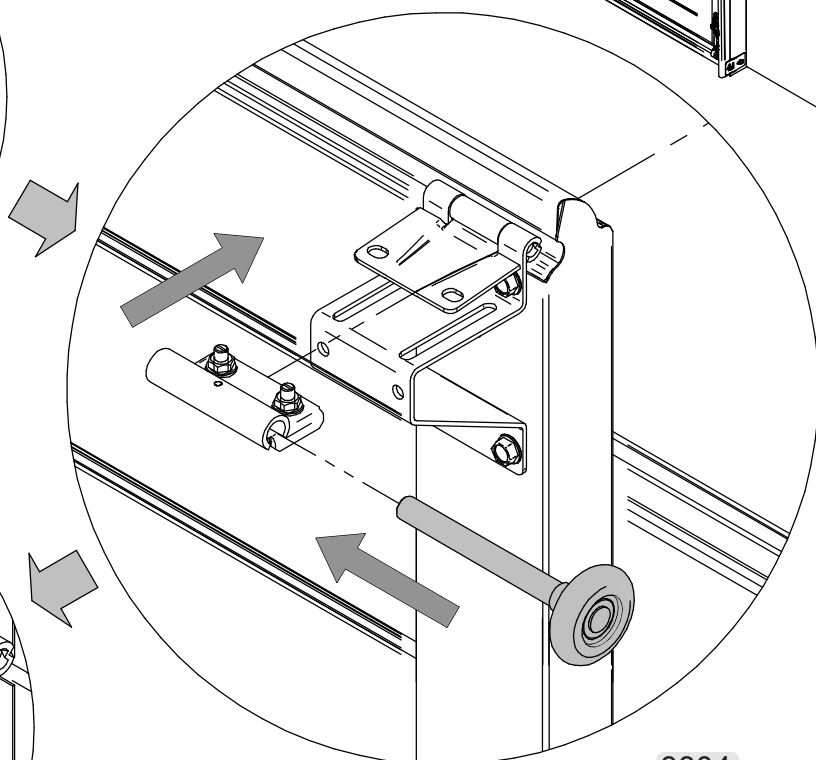
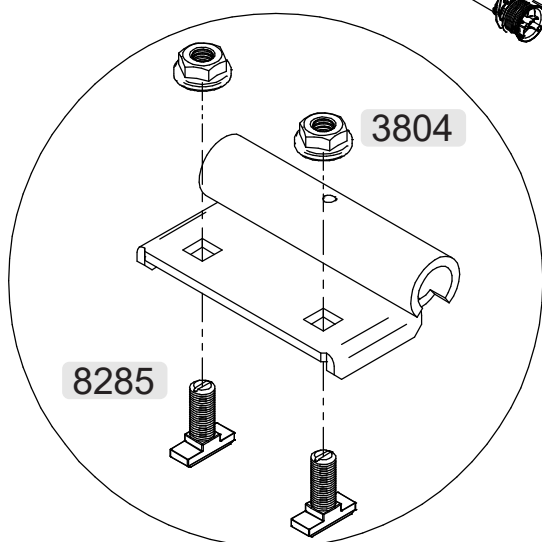
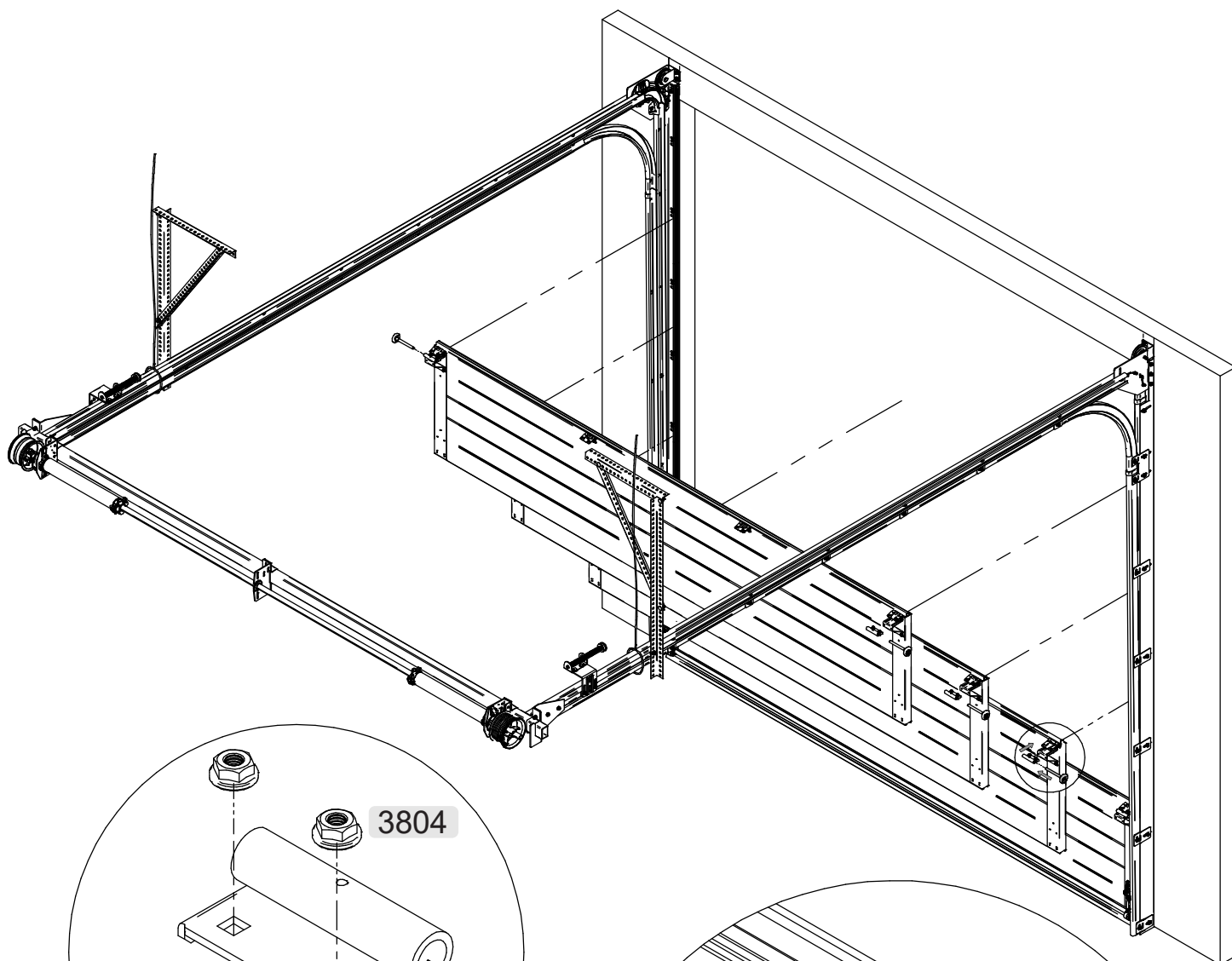

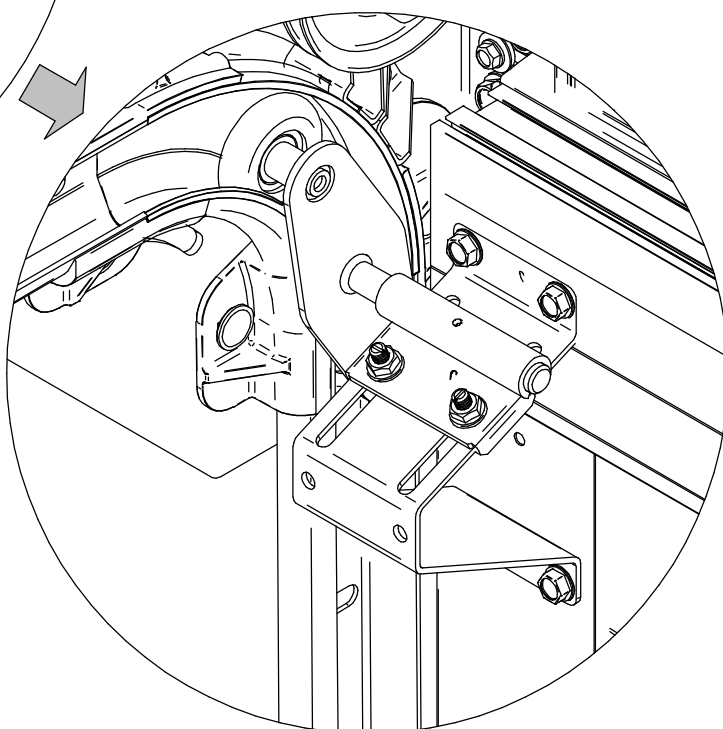
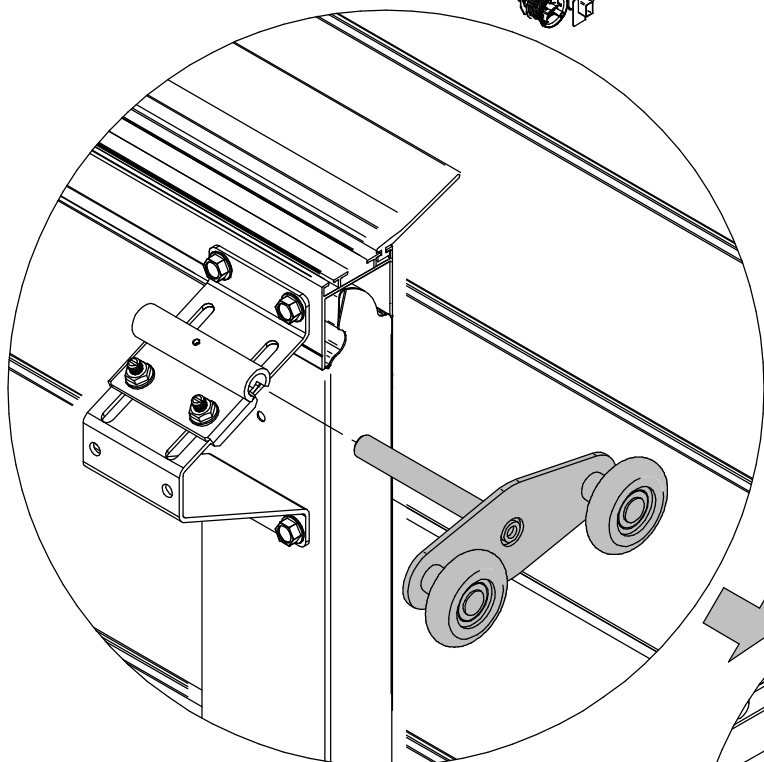
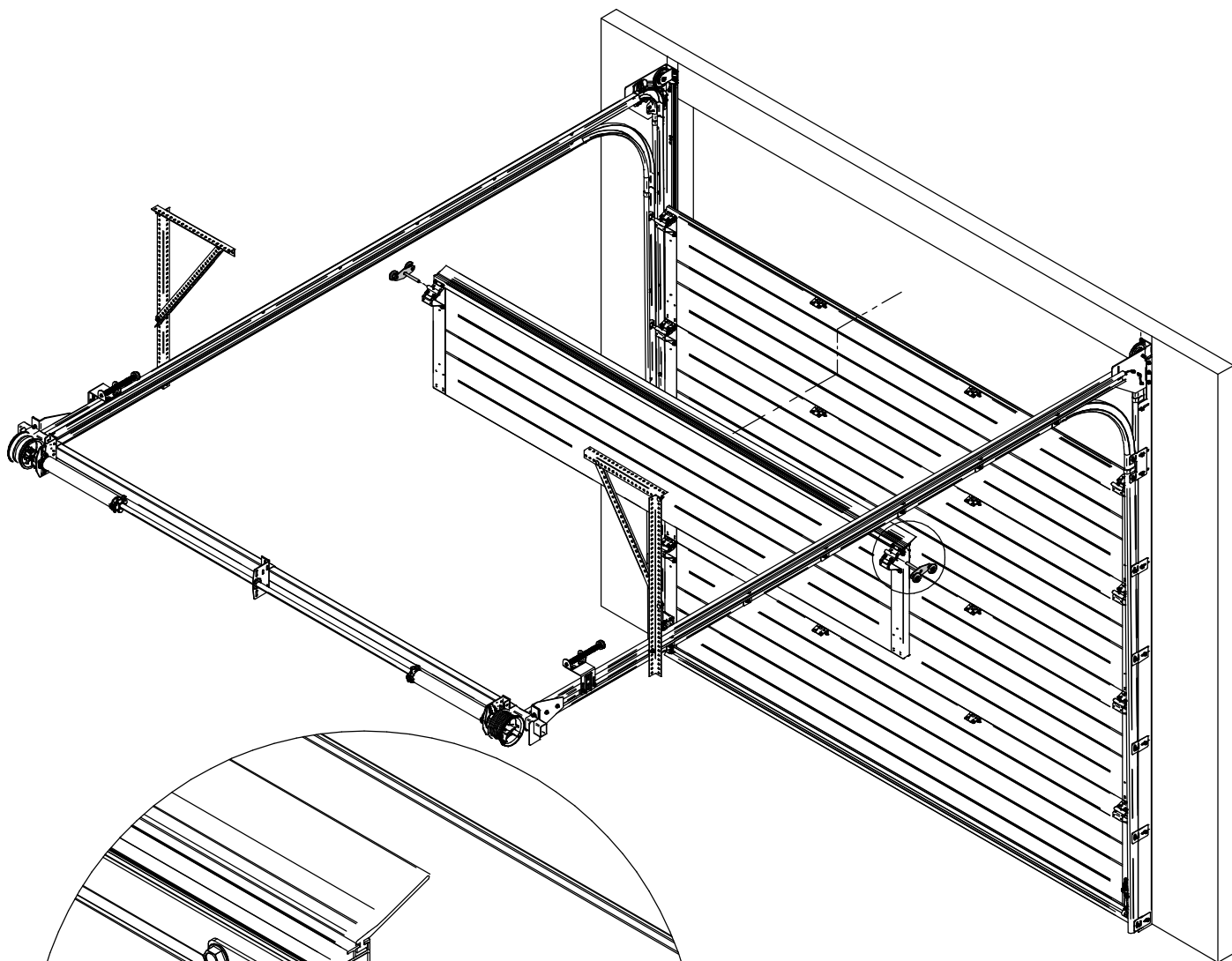

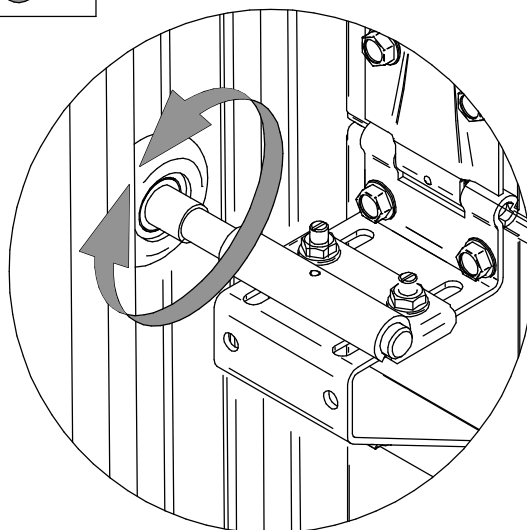
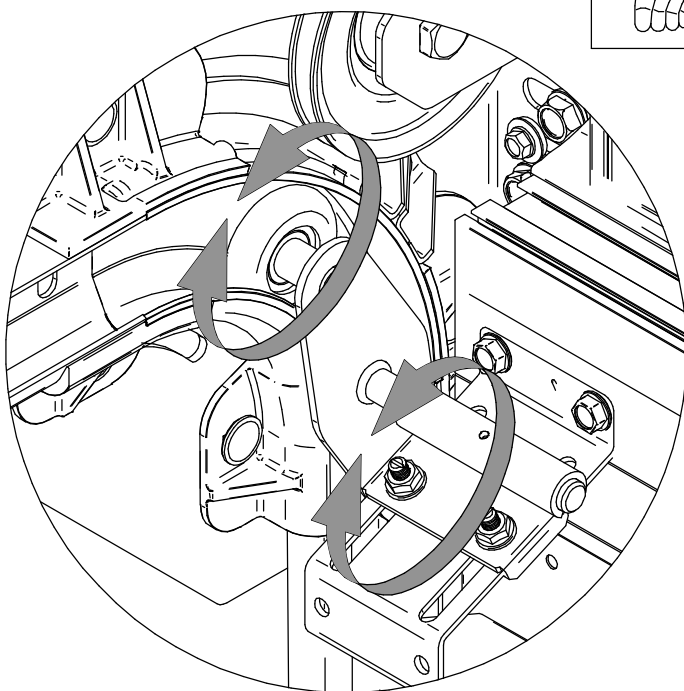
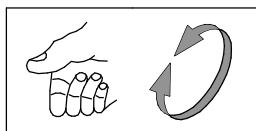
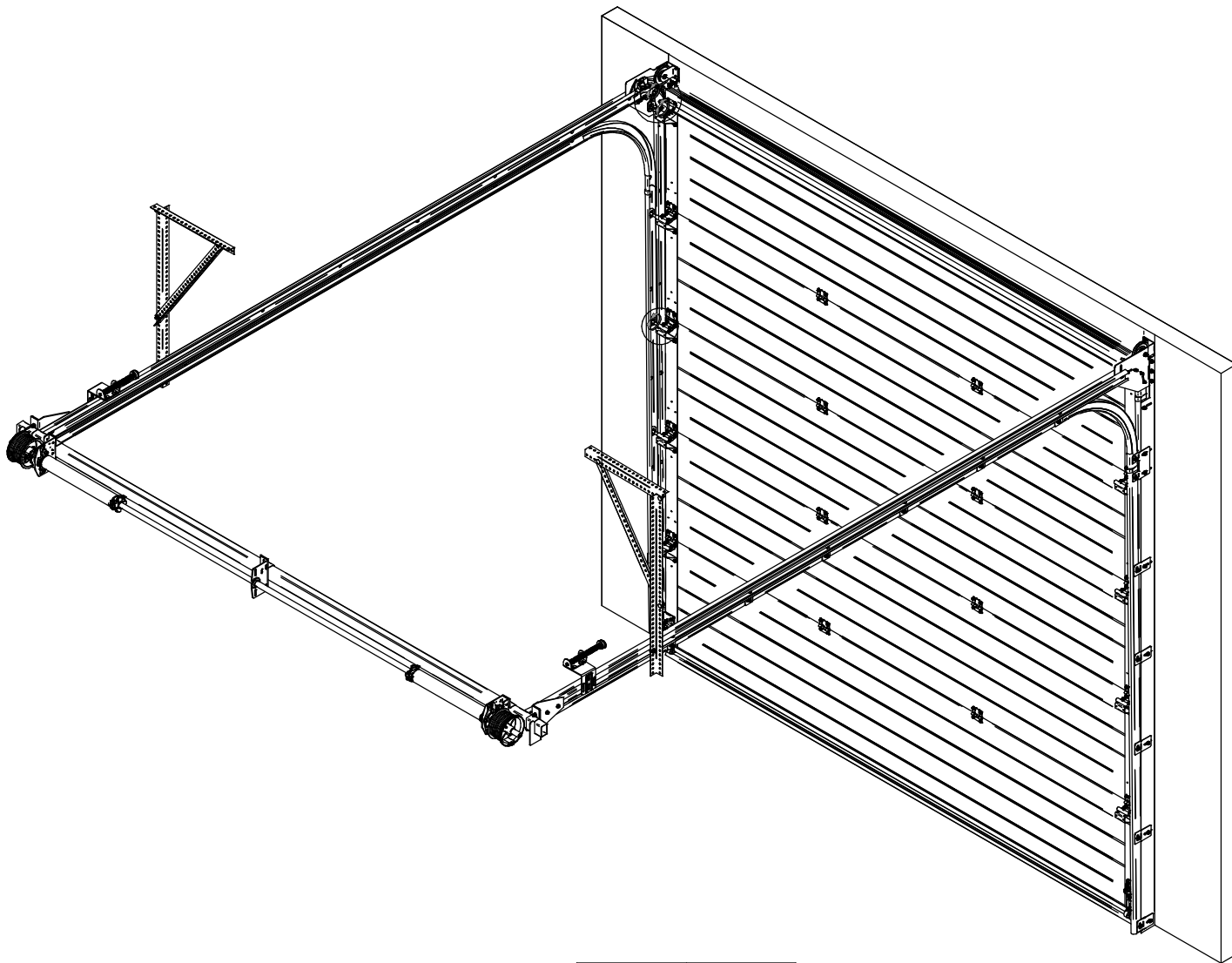



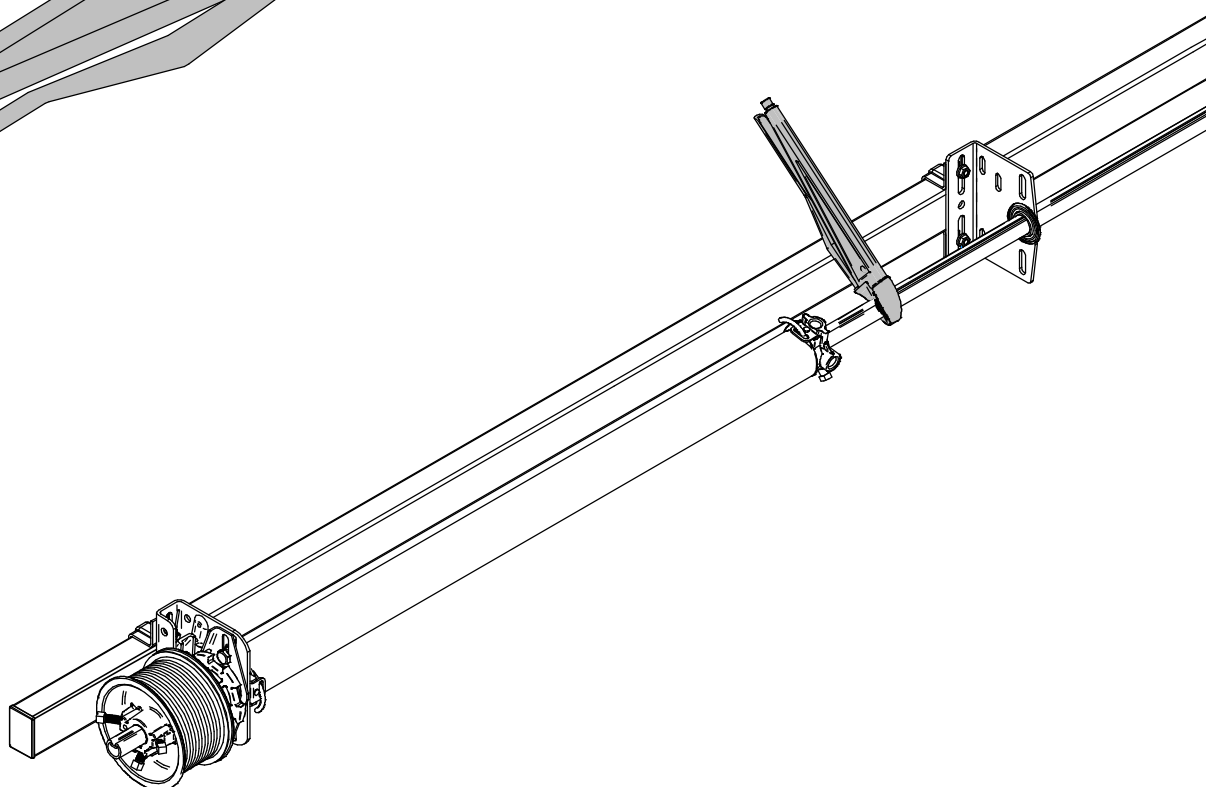
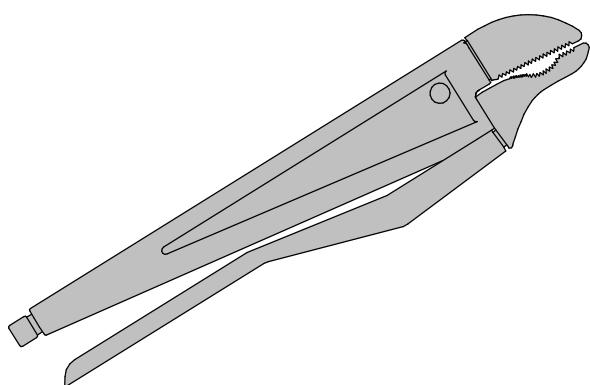
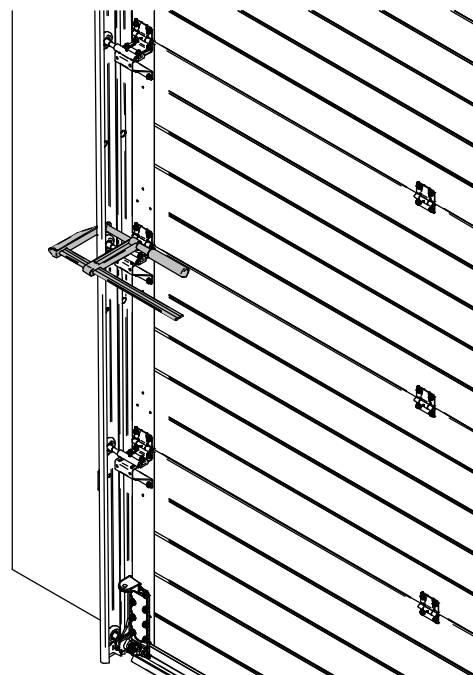
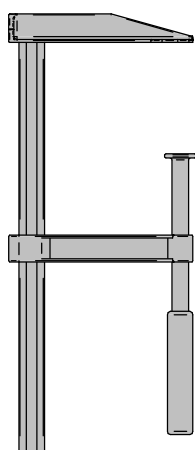

1

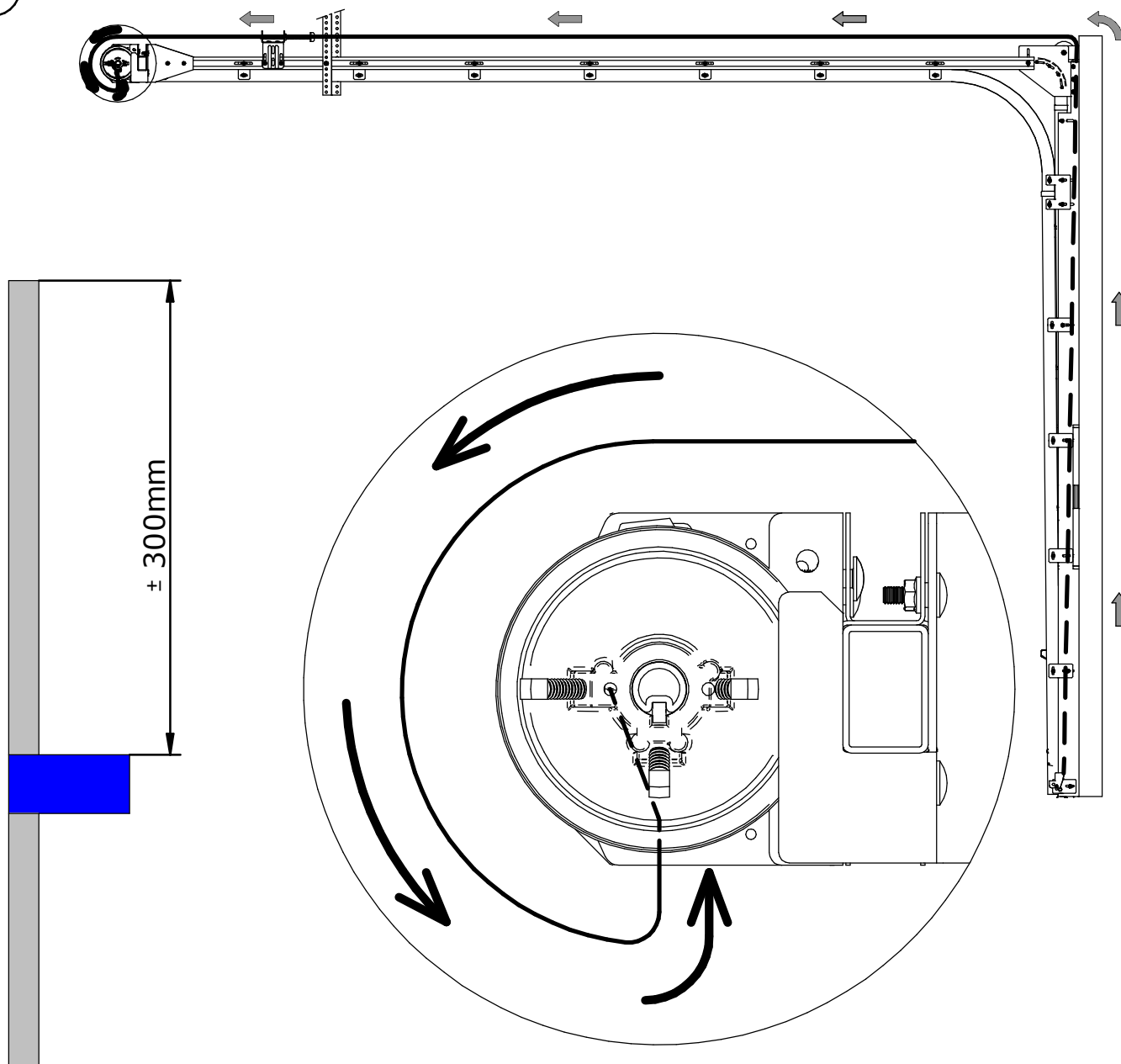

2

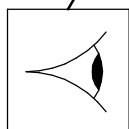
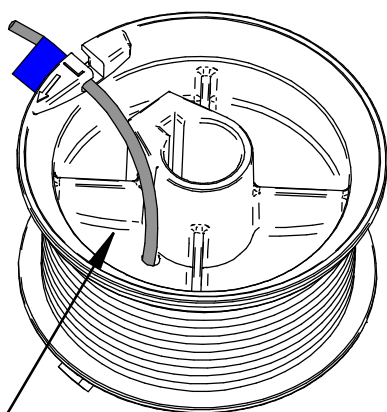

3

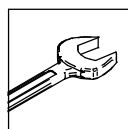
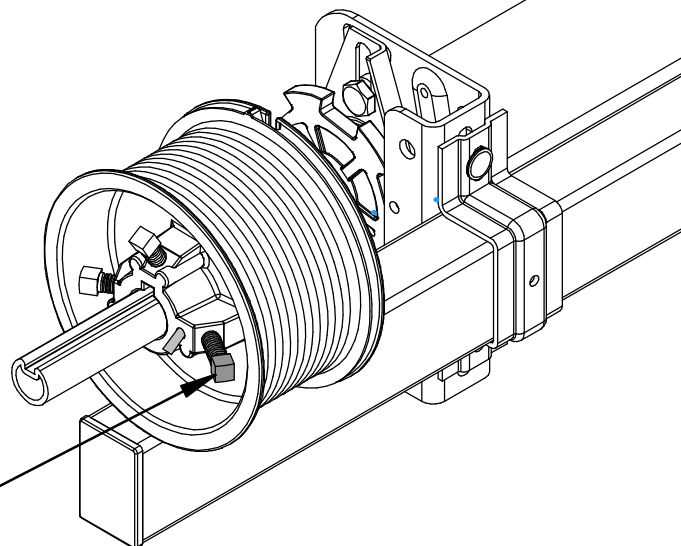



Option  
Optie

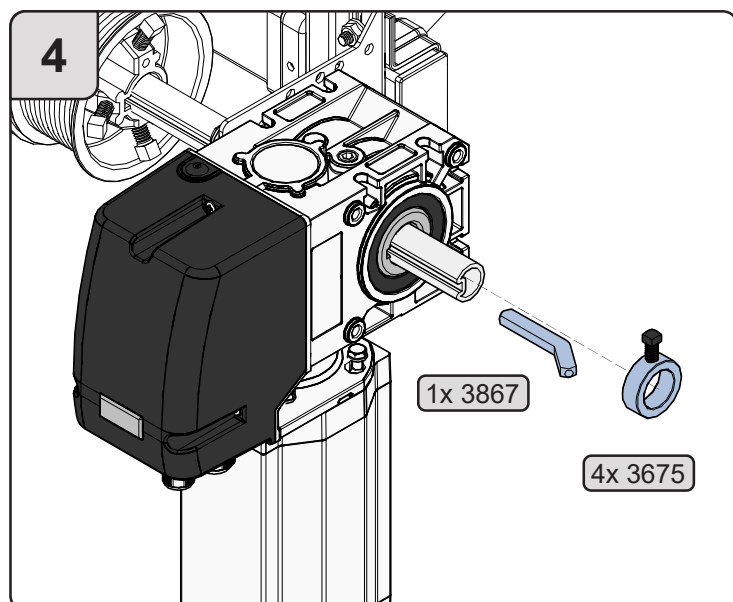
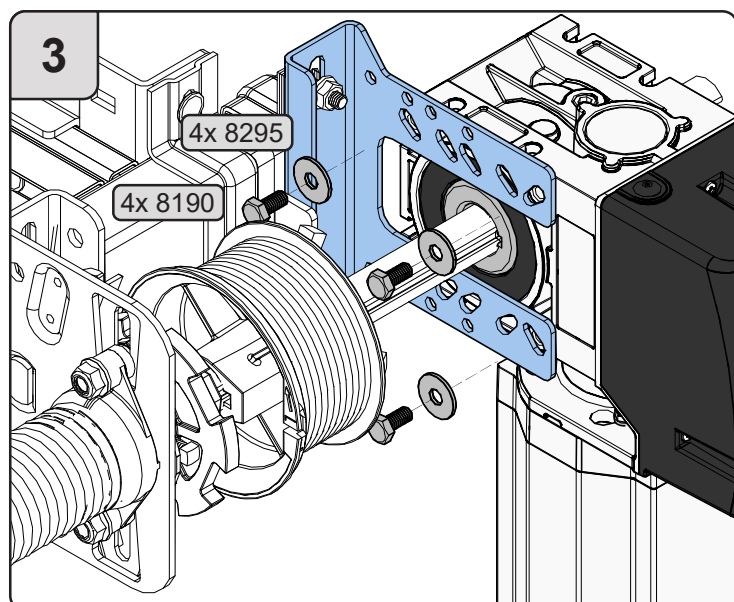
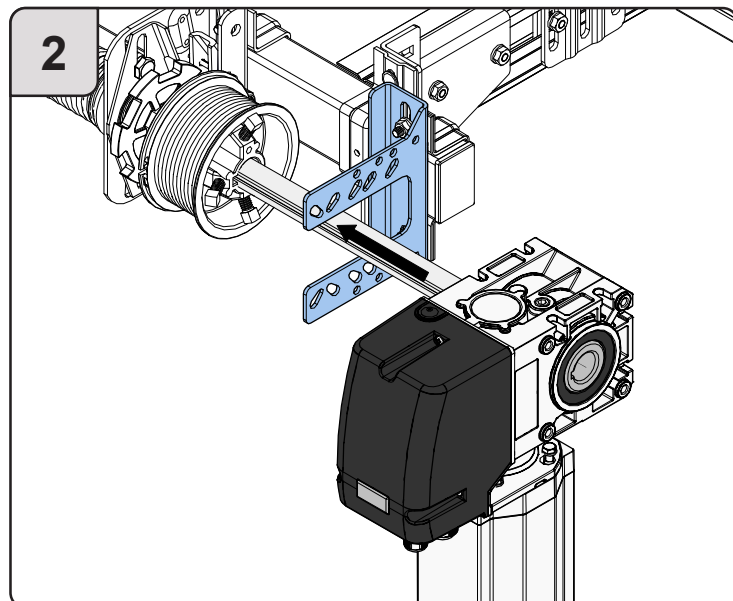
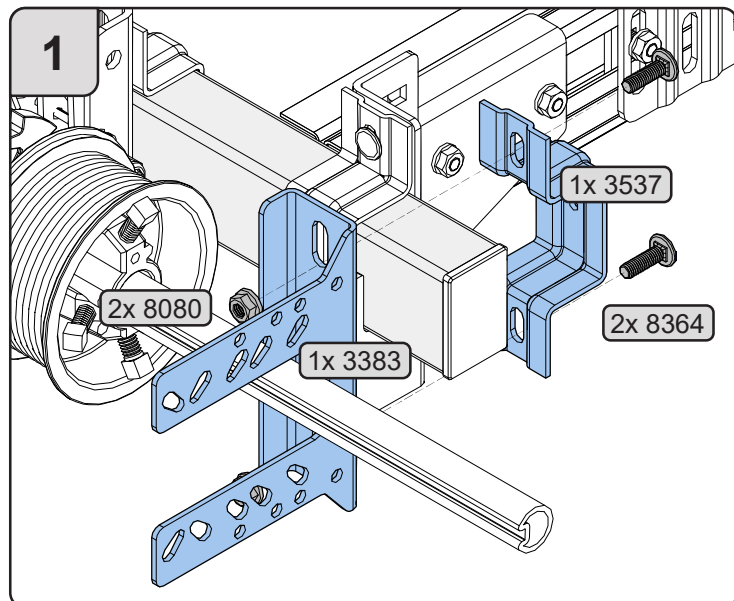

## Option Optie

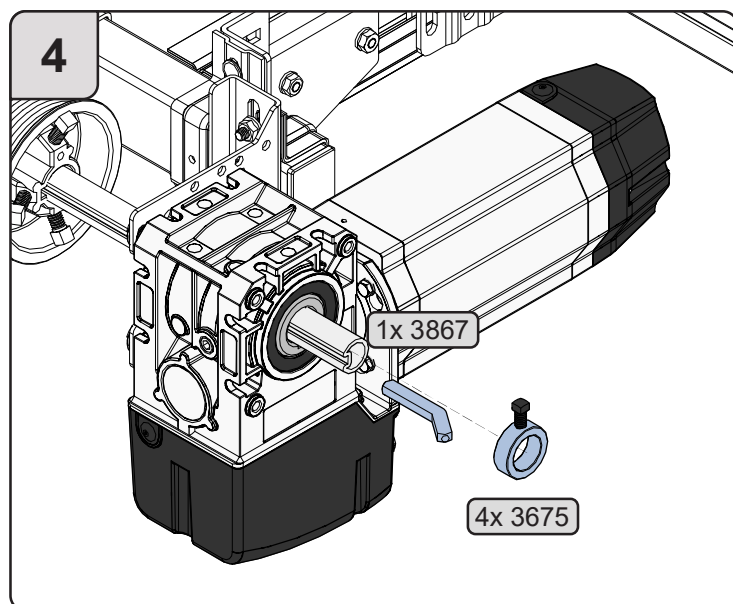
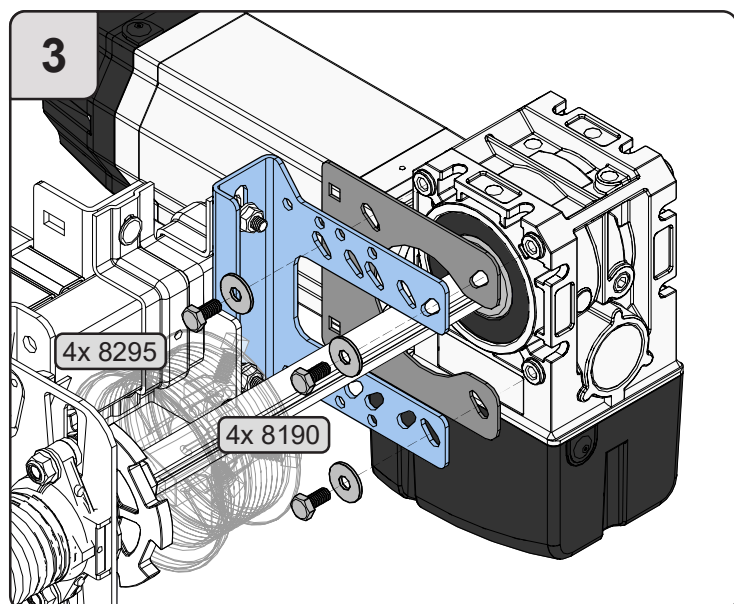
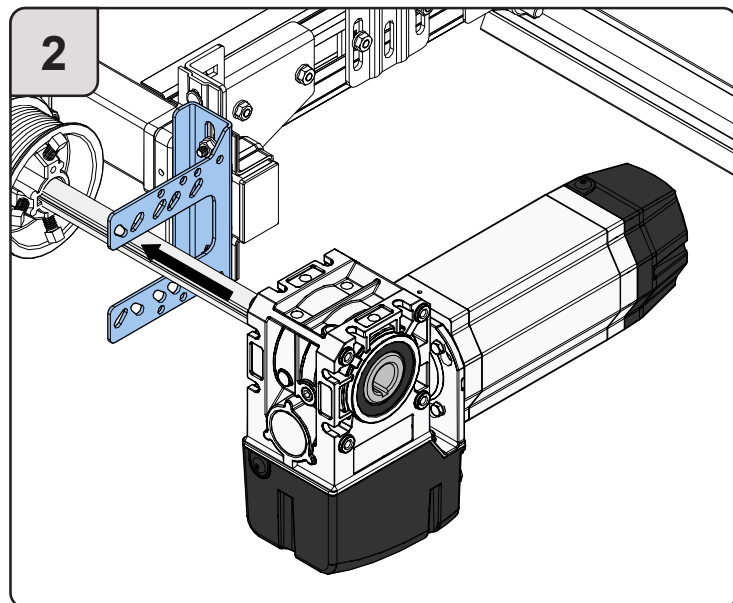
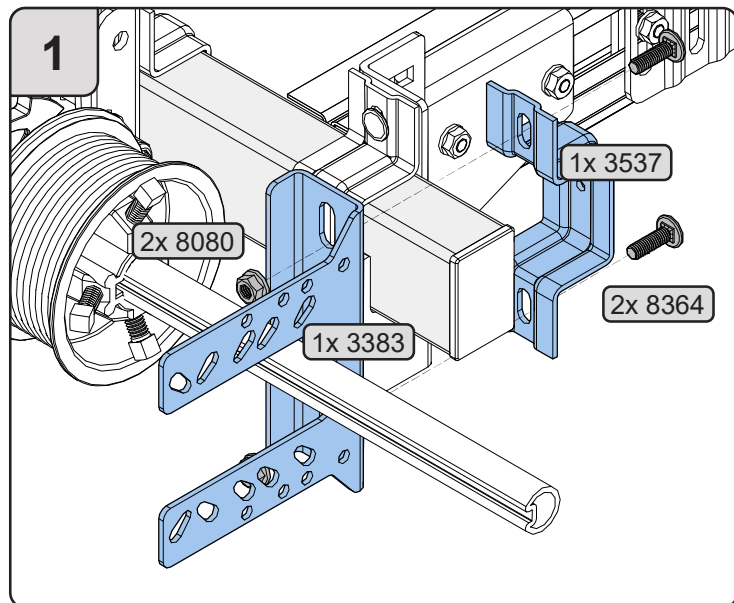

Turns x 360°

# PW 12 Bon Hardware Industrie

Pitch Hilift

0

0

E

Aant Deurtype DMB DMH Secties Velden Beslag Gewicht Turns

Klant  
Klant  
referentie:  
Transport

x

11.4

| Aant | Eenheid | Art. nr. | Artikel omschrijving                   | Doos | Lengte | Verpakt / Controle                                |
|------|---------|----------|--|------|--------|---|
| 1    | -       |          | Springs Left 6,00x51x950 Powdercoated  |      |        | <input type="checkbox"/> <input type="checkbox"/> |
| 1    | -       |          | Springs Right 6,00x51x950 Powdercoated |      |        | <input type="checkbox"/> <input type="checkbox"/> |



VEER / FEDER / SPRING / RESSORT < 152 mm

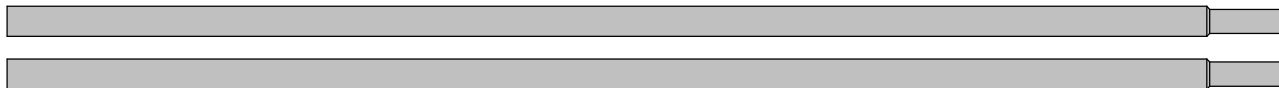

VEER / FEDER / SPRING / RESSORT < 67 mm

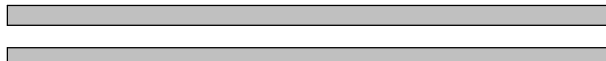

STAAL / STAHL / STEEL / ACIER 52

1

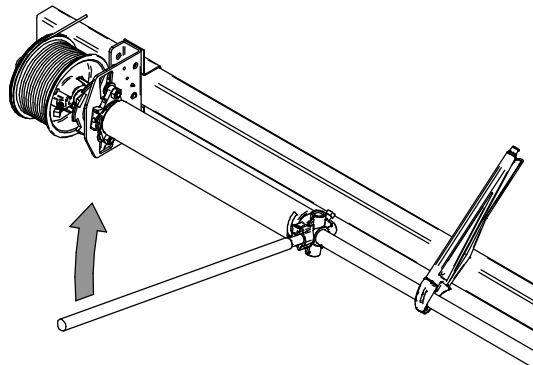

2

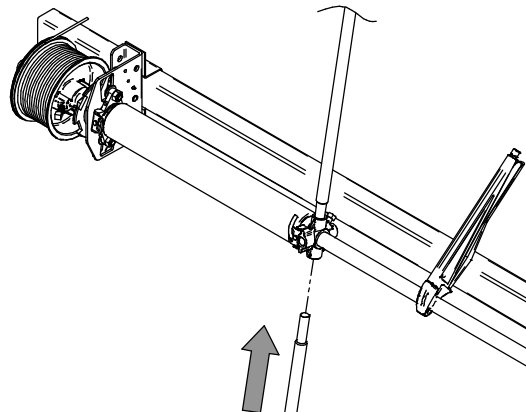

3

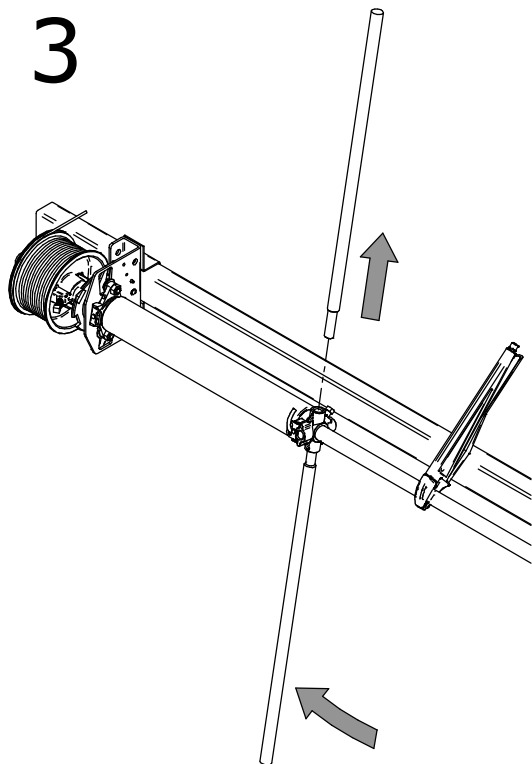

4

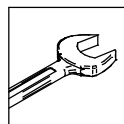
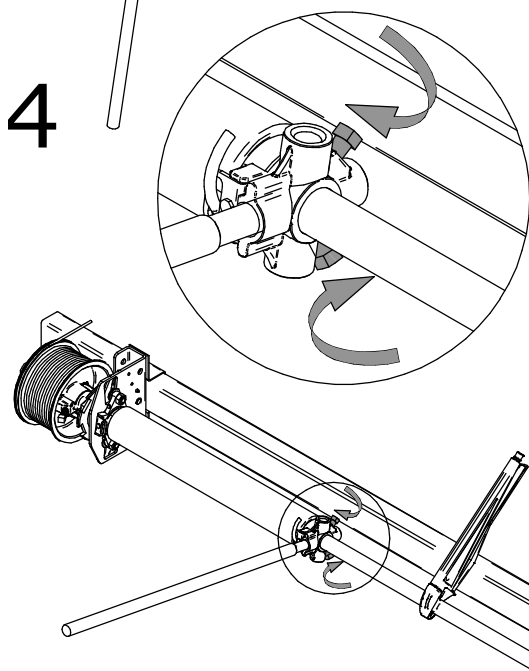

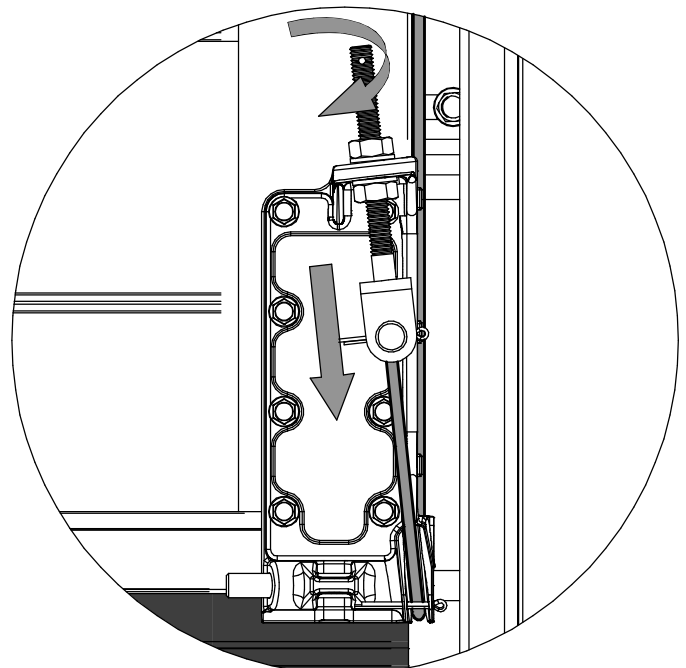
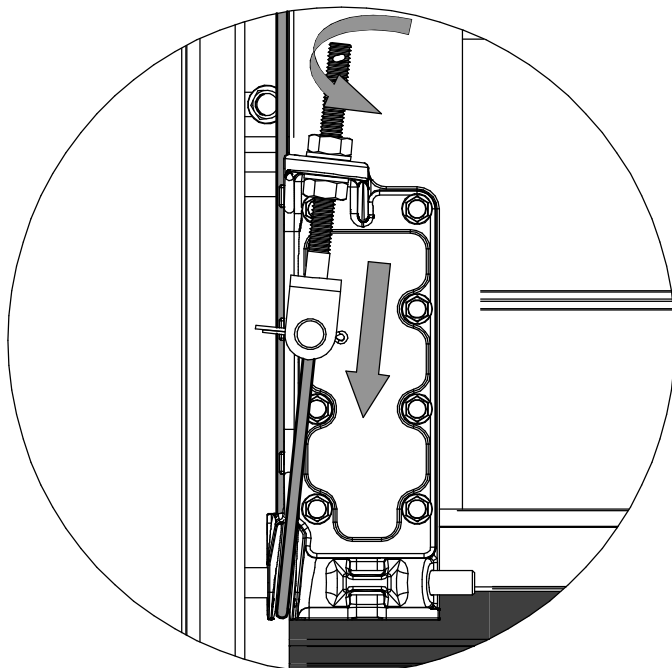
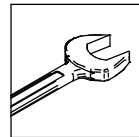
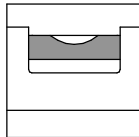
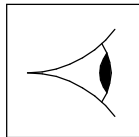
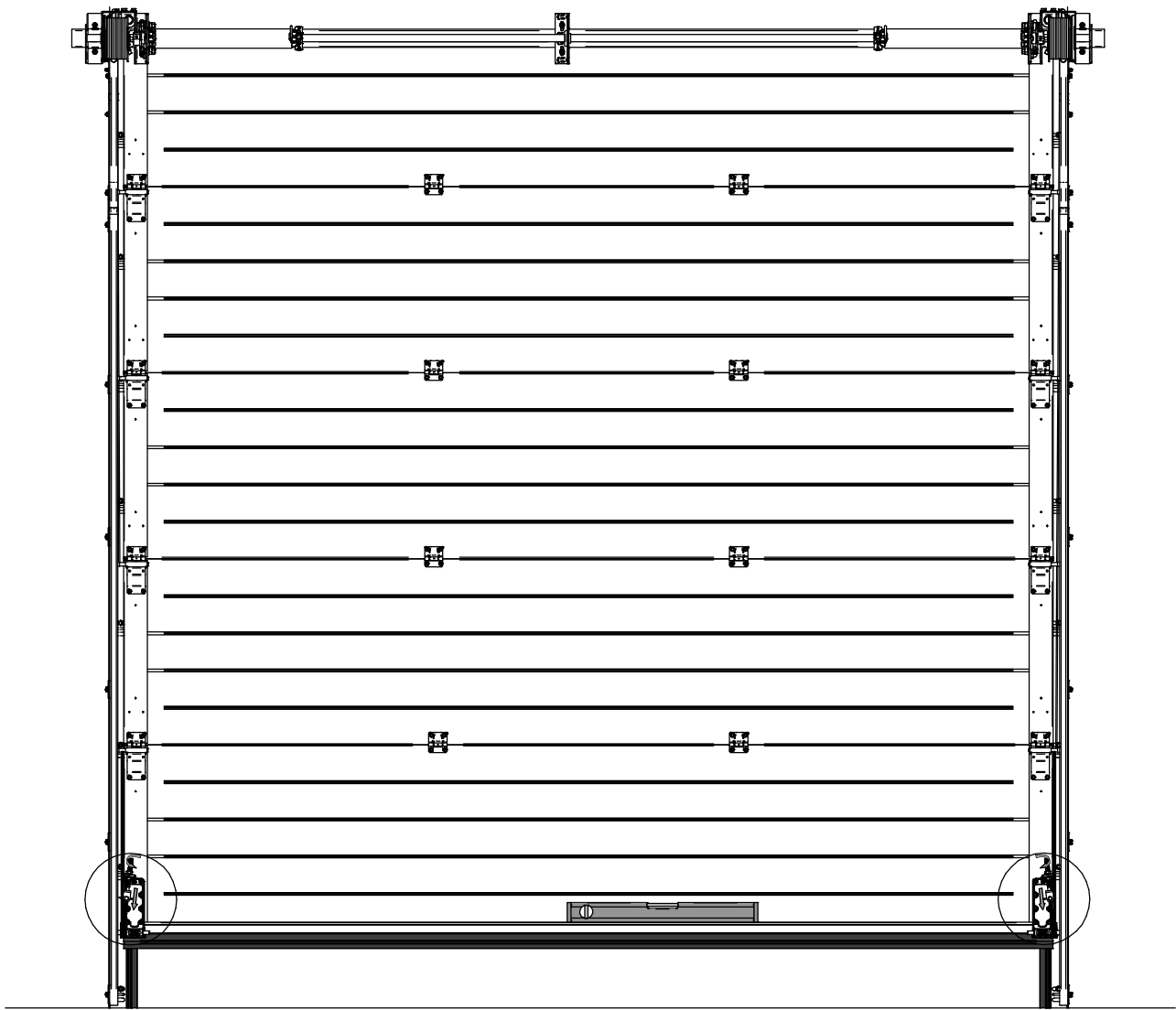

# Option Optie

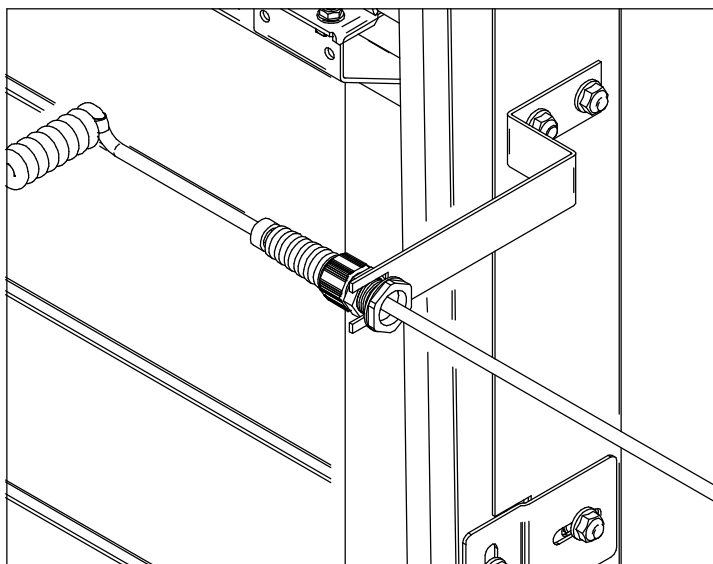
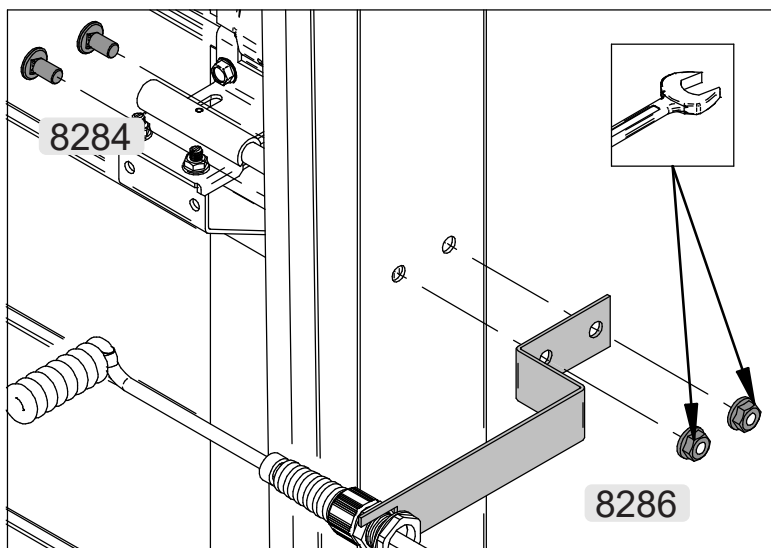
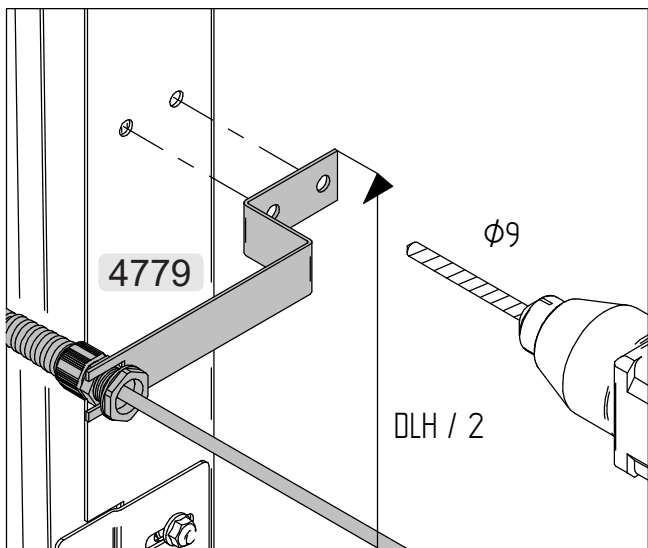
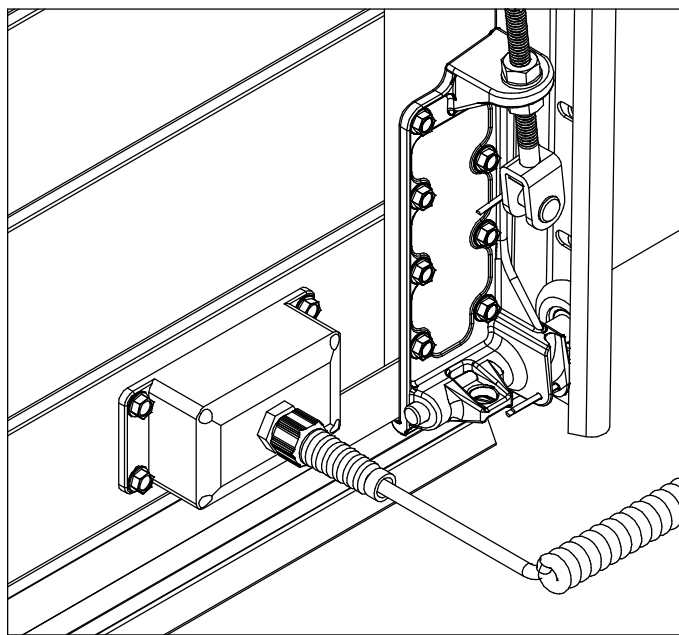
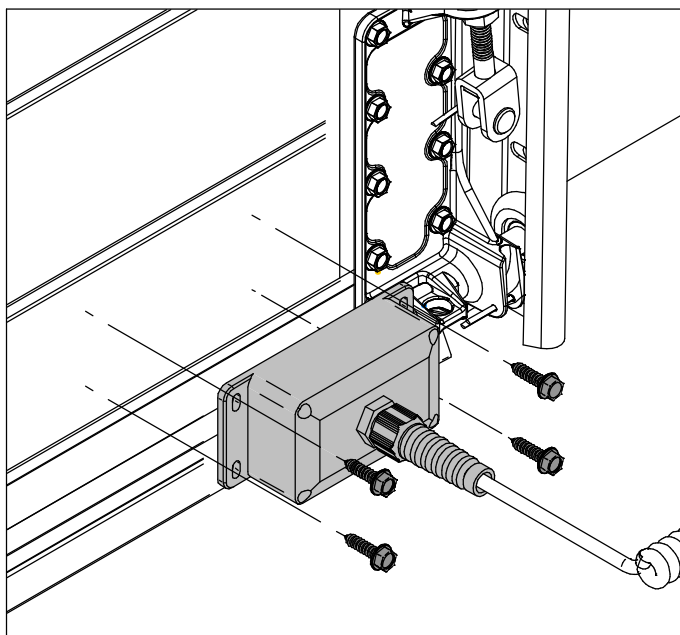



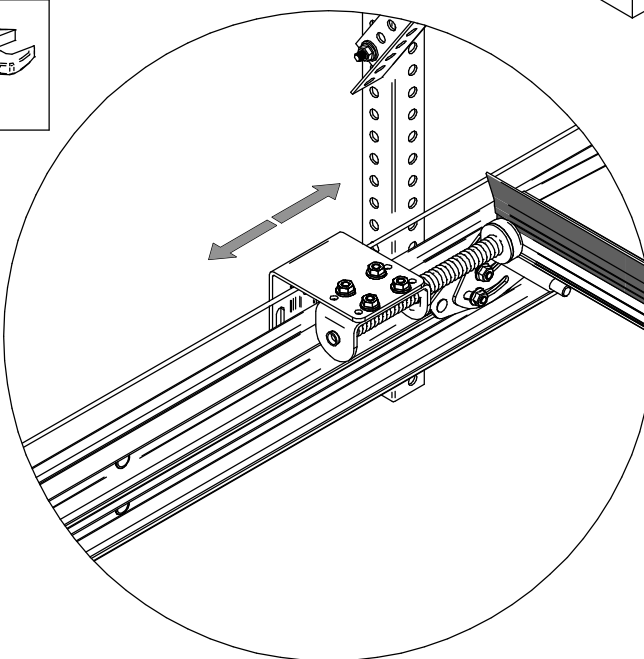
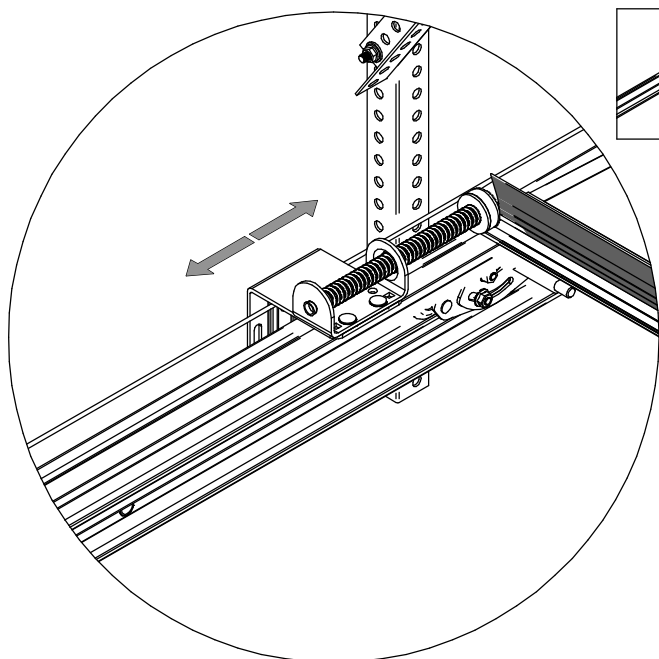
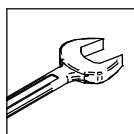
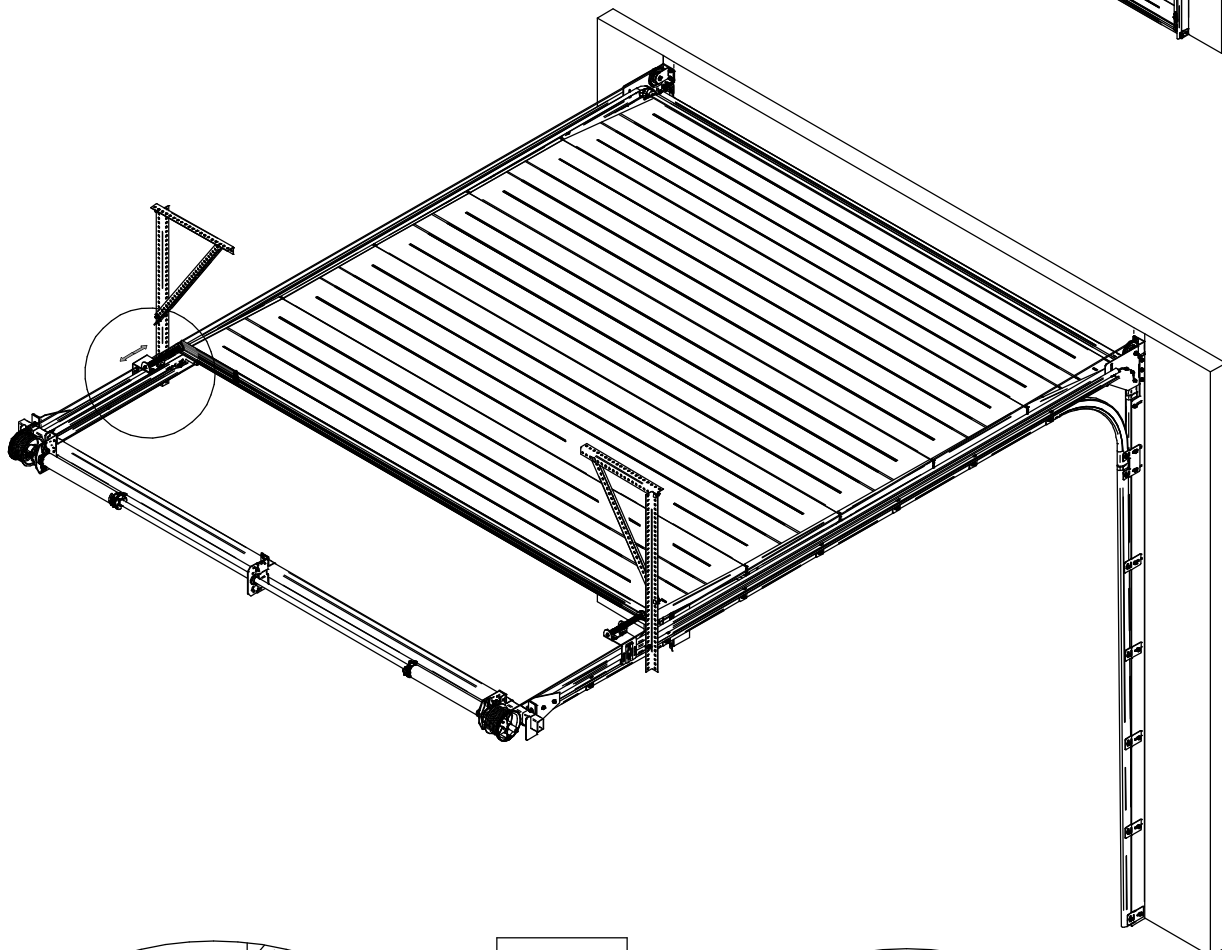
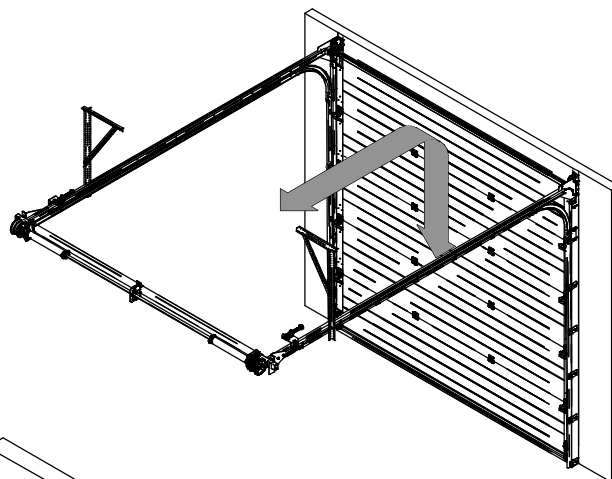
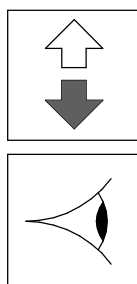

# LS200

